



081-12493-00 (8570G)

September 13, 2012

Director, Environmental Approvals - Access and Service Integration Branch
Ministry of Environment
2 St. Clair Avenue West, Floor 12A
Toronto, ON M4V 1L5

Re: Environmental Compliance Approval Application
Amendment to Environmental Compliance Approval No. A371203
Waste Management of Canada Corporation – Richmond Landfill Site

Dear Sir/Madam:

Please find attached an Environmental Compliance Approval application and supporting documentation in regards to our request for an amendment to Environmental Compliance Approval No. A371203, issued to Waste Management of Canada Corporation (WM) for the Richmond Landfill site located in the Town of Greater Napanee, ON. We have prepared this package after discussions with WM, and provide this on their behalf.

We have prepared an Environmental Compliance Approval (ECA) Application to amend the ECA for the landfill site, which is attached to this document, along with other supporting documentation, as listed below:

- This letter;
- Attachment 1 – Proof of Legal Name;
- Attachment 2 – Development and Operations Report for a Waste Transfer Station Application, updated by GENIVAR Inc., September 2012;
- Attachment 3 – Site Location Map;
- Attachment 4 – Georeferencing Information;
- Attachment 5 – Documentation in support of EBR Exception, in the form of an email exchange between Mr. Randy Harris, WM Landfill Manager, and Mr. David Arnott, Provincial Officer, Ministry of Environment, Kingston District Office;
- Attachment 6 – Proof of Consultation/Notification; and
- Application fee.

In the fall of 1995, a mini-transfer (public drop-off) area was constructed for small vehicles off-loading waste, recyclables, and compostable material at the Richmond Landfill. This area, which is located to the west of the weigh scales, houses containers which have been provided for cars and small vehicles to discharge waste into. The containers are then taken to an approved off-site facility for final disposal. In 2009, WM constructed a reuse centre where residents can donate and exchange reusable goods. WM also entered the Ontario Electronic Stewardship program and the Ontario Tire Stewardship program, which permits the site to accept electronics and tires from residents, for recycling offsite.

On June 30, 2011, the Richmond Landfill ceased to accept waste for final disposal, and the public drop off area was closed to the public. On January 9, 2012, the Ministry of Environment issued Environmental Compliance Approval No. A371203, which permitted the operation of the public drop off area subject to the terms and conditions outlined in the Environmental Compliance Approval. The public drop off facility

is open to residents who generate waste within the boundaries of the Town of Greater Napanee, the Town of Deseronto, Tyendinaga Township, and the Mohawks of the Bay of Quinte. To date, the mini-transfer area has operated well with no issues.

WM is submitting this application to request an amendment to Condition 5.18 (1) of Environmental Compliance Approval No. A371203 for the Richmond Landfill. The condition currently states the following:

"Waste materials shall be removed from the Waste and Recycling Drop-Off Facility on a minimal frequency of twice per week, with the exception of white goods and blue box materials."

Due to the low volume of waste that is brought to the public drop off area, WM is requesting that the aforementioned removal frequency be modified from twice per week, to once every two weeks. The attached Development and Operations Report for a Waste Transfer Station addresses WM's actions regarding the control of odours and vermin at the public drop off area pertaining to the increased time of retention of waste at the site. As well, in the event that the maximum storage capacity outlined in Condition 5.14 (3) is reached prior to the biweekly removal date, WM will ensure that the waste is immediately removed to one of the approved offsite disposal facilities.

There are no changes proposed to the materials accepted at this facility, nor are there any proposed changes to the hours of operations.

We trust that the enclosed information meets your requirements and will facilitate your approval. Should you have any questions regarding this application, please do not hesitate to contact the undersigned.

Yours truly,
GENIVAR Inc.

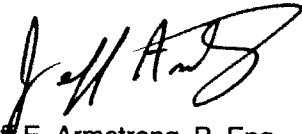

Jeff E. Armstrong, P. Eng.,
Director – Solid Waste Management
JEA/BDL/bdl
Encl.

cc: Mr. Trevor Dagilis, District Manager, MOE – Kingston District
Mr. David Arnott, Senior Environmental Officer, MOE - Kingston District
Mr. Randy Harris, Landfill Manager, Waste Management of Canada
Mr. Wayne Jenken, Area Landfill Engineer, Waste Management of Canada
Mr. Reid Cleland, Director of Disposal Operations – Ontario, Waste Management of Canada
Public Liaison Committee
Mayor Gordon Schermerhorn, Town of Greater Napanee
Raymond Callery, CAO, Town of Greater Napanee
Reeve Rick Phillips, Tyendinaga Township
Steve Mercer, CAO, Tyendinaga Township
Chief Don Maracle, Mohawks of the Bay of Quinte
Dan Brant, CAO, Mohawks of the Bay of Quinte

Environmental Compliance Approval Application

General Information and Instructions	2	3 Regulatory Requirements	14	5.5 Waste Management Systems (Except Mobile Waste Processing)	30
Application Summary	4	3.1 Environmental Bill of Rights (EBR) Requirements	14	5.6 Waste Management System – Mobile Waste Processing	36
Required Information	5	3.2 Environmental Assessment Act (EAA) Requirements	14	5.7 Cleanup of Contaminated Sites	38
1 Applicant Information	6	3.3 Consultation/Notification	15	6 Supporting Documentation and Technical Requirements	39
1.1 Applicant Information	6	4 Site Information	16	6.1 General	39
1.2 Applicant Physical Address	6	4.1 Site Address or Storage Location	16	6.2 Air	40
1.3 Applicant Mailing Address	7	4.2 Site or Storage Location Information	17	6.3 Noise and Vibration	40
1.4 Statement of the Applicant	7	4.3 Site Zoning and Classification	17	6.4 Sewage	41
1.5 Statement of the Municipality	7	4.4 Point of Entry into Ontario	18	6.5 Waste Disposal Sites	42
2 Project Information	8	4.5 Source Protection/Drinking Water Threats	18	6.6 Waste Management Systems	42
2.1 Reason for Application	8	4.6 Receiver of Effluent Discharge	19	6.7 Mobile Waste Processing	43
2.2 Project Type	8	5 Facility Information	20	6.8 Cleanup of Contaminated Sites	43
2.3 Approval Information	9	5.1 Air	20	6.9 Other Attachments	43
2.4 Other Approval/Permits for Facility	9	5.2 Noise	22	7 Payment Information	45
2.5 Technical Contacts	10	5.3 Sewage Works	24		
		5.4 Waste Disposal Site	26		

ontario.ca/environment

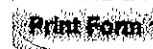

General Information and Instructions

General Information:

Information requested in this form is collected under the authority of the Environmental Protection Act (EPA), Ontario Water Resources Act (OWRA) and Environmental Bill of Rights (EBR), and will be used to evaluate applications for Environmental Compliance Approvals (ECAs) issued under Part II.1 of the EPA. This application form should not be used for *mobile PCB destruction facilities* and *land application sites of septage and biosolids*.

For all questions related to preparing or submitting this form or about the Ministry's collection of information related to applying for an ECA, contact:

Environmental Approvals Access and Service Integration Branch

2 St. Clair Ave. West, Floor 12A,
Toronto, Ontario M4V 1L5.

Telephone outside Toronto 1-800-461-6290
or in Toronto 416-314-8001.

This office can also provide you with
copies of application forms and supporting
documentation.

Instructions:

1. Applicants are responsible for ensuring that they complete the most recent application form.
Application forms and information about the required supporting documentation and technical requirements are available from the **Environmental Approvals Access and Service Integration Branch** (the address and phone number are provided in the General Information on this page). As well, you can get this information from your local District Office of the Ministry of the Environment, and on the Resources section of the Ministry of the Environment website at: www.ene.gov.on.ca/environment/en/resources/Index.htm.
2. A complete application consists of:
 - a completed and signed application form;
 - all required supporting documents and technical requirements identified in:
 - i. this form,
 - ii. Ministry guidance,
 - iii. the Applications for Environmental Compliance Approvals regulation, and
 - payment of the application fee (in Canadian funds) by certified cheque or money order made payable to the Minister of Finance, or credit card payment (for payments up to \$10,000). For *Transfer of Review*, make your cheque or money order payable to the appropriate municipality.

The Ministry may return incomplete applications to the applicant. The Director may require additional information of any application initially accepted as complete.

3. Submit the complete application as follows:
 - One (1) paper copy (unless your application is a *Transfer of Review*), one (1) electronic copy and the fee to the **Director, Environmental Approvals Access and Service Integration Branch** at the address provided in the General Information on this page.
 - If your application is a *Transfer of Review*, you must submit two (2) copies of the completed application and the fee to the designated municipal authority.
4. You must also send a copy of the application without the fee to the local Ministry District Office that has jurisdiction over the area where the facilities are located. DO NOT send payment to the District Office.
 - To locate the appropriate local Ministry District Office, visit the Ministry of the Environment website at: www.ene.gov.on.ca/environment/en/about/regional_district_offices/Index.htm.
5. For Waste Disposal Sites you must also send a copy of the application without the fee to the Clerk's office of the local municipality (both upper and lower tier) in which the facility/proposed facility is located unless the application is for a revocation or an amendment that is environmentally insignificant or the applicant is a

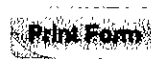

municipality. DO NOT send any payment information to the municipality.

Information collected by the Ministry of the Environment is subject to the Freedom of Information and Protection of Privacy Act (FIPPA). If you are of the view that any part of application is confidential on the grounds that such information constitutes a trade secret or scientific, technical, commercial, financial or labour relations information, please make this known now. Otherwise, the Ministry may make the information available to the public without further notice to you.

It is an offence under the EPA and OWRA to provide false or misleading information in this application and/or accompanying documents.

The Electronic Form Smart Features

The electronic version of this form incorporates several features to assist you with completing your application.

The electronic form will highlight required information with **red** and **green** indicators. **Red** means that the information is required before the section is complete.

The form will also calculate certain values based on the information you enter and will assist you in ensuring that all required information is included with your application. You can save a copy of this form that includes any information you have entered.

These features are available in Adobe Reader version 8 or above. You can download a copy from the website at: <http://get.adobe.com/reader/otherversions/>.

Smart Features Legend:

These active buttons appear throughout the Application form to provide additional support.

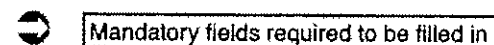

Mandatory fields required to be filled in

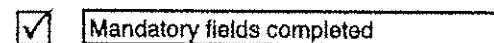

Mandatory fields completed

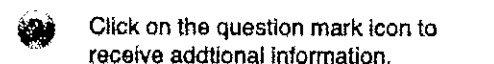

Click on the question mark icon to receive additional information.

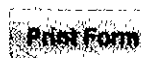

Print Form Button — Prints the entire form.

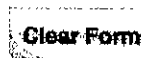

Clear Form Button — Clears the entire form.



Save Form Button — Saves the entire form.



Calculate Button — Calculates fees.

© Queen's Printer for Ontario, 2011

Ministry of the Environment
Public Information Centre:
Telephone: 416-325-4000
Toll-free: 1-800-565-4923
E-mail: picemail.moe@ontario.ca
www.Ontario.ca/Environment

Print Form

Clear Form

Save Form

For Office Use Only

Reference Number	Payment Received	Date (yyyy/mm/dd)	Initials
	\$		

Application Summary

Applicant Name 

Waste Management of Canada Corporation

Project Name 

Application to Amend Environmental Compliance Approval No. A371203 - Waste Transfer Station - Richmond Landfill

Project Description Executive Summary 

On January 9, 2012, the Ministry of the Environment issued Environmental Compliance Approval (ECA) No. A371203 for the Richmond Landfill. Conditions 5.12 through 5.24 inclusive were added to the ECA, which permitted the operation of the public drop off area to resume at the landfill. Condition 5.18(1) states that waste materials are to be removed from the public drop off facility on a minimal frequency of twice per week, with the exception of white goods and blue box materials. Waste Management is seeking an amendment to Condition 5.18(1) to decrease the minimal removal frequency from twice per week to once every two weeks. Waste from the public drop off area will continue to be hauled to transfer stations in either Trenton, Ontario or Kingston, Ontario for disposal. Daily maximum amounts of waste and recyclable materials received at the site will not exceed 50 tonnes per day, except for the occasions outlined in Condition 5.14 (2). The maximum storage capacity is 50 tonnes. The public drop off area services residents of the Town of Greater Napanee, the Town of Deseronto, Tyendinaga Township, and the Mohawks of the Bay of Quinte. Operating hours of the facility are from Monday to Friday, 8 a.m. to 5 p.m., and Saturday, 8 a.m. to 1 p.m.

Print Form

Clear Form

Save Form

Required Information

Project Name & Description	Completed (yes or no)
Section 1: Applicant Information	Yes
Section 2: Project Information	Yes
Section 3: Regulatory Requirements	Yes
Section 4: Site Information	Yes
Section 5: Facility Information	Yes
Section 6: Supporting Documentation	Yes
Section 7: Payment Information	Yes

Fee Summary:

Administrative Processing	\$	200.00
Review of EPA s. 9 activities	\$	0.00
Review of EPA s. 27 activities	\$	100.00
Review of OWRA s. 53 activities	\$	0.00
Total Fee	\$	300.00

Calculate

Application Status Form Complete

The Ministry may request additional fees upon review of this application.

If you are submitting this form in print version only and are not using the smart calculation feature, please attach the fee calculation separately.

Supplemental Application Information

See help text on required information for this section. 

Proposed start date: As soon as possible.

Copies to:

District Manager, MOE - Kingston District Office
 Senior Environmental Officer, MOE - Kingston District Office
 Landfill Manager, Area Landfill Engineer and Director of Disposal
 Operations Ontario, Waste Management of Canada
 Public Liaison Committee
 Mayor and CAO - Town of Greater Napanee
 Reeve and CAO - Tyendinaga Township
 Chief and CAO - Mohawks of the Bay of Quinte

Print Form

Clear Form

Save Form

1.1 Applicant Information

Applicant Name (legal name of individual or organization as evidenced by legal documents)

Waste Management of Canada Corporation

Business Number

001600554

Business Name same as Applicant Name

Waste Management of Canada Corporation

Business Website Address:

Applicant Type:

- Corporation
- Individual
- Partnership
- Sole Proprietor
- Federal Government
- Municipal Government
- Provincial Government
- Other (describe):

Primary North American Industry Classification System (NAICS) Code ▼

562210 Waste Tre

Other NAICS codes (select all that apply) ▼

Separate list attached? Yes No

Business Activity Description

Waste Management owns and operates solid waste collection and disposal facilities.

1.2 Applicant Physical Address

Civic Address – Street Information (includes street number, name, type and direction)

1271 Beechwood Road

Unit Identifier (suite or unit number)

Survey Address

Lot	Concession	Part	Reference Plan

Municipality/Unorganized Township or Territory Upper Tier/District

Town of Greater Napanee

Province/State

Ontario

Country

Canada

Postal Code/ZIP Code

K7R 3L1

Telephone Number (include area code & ext.)

(613) 388-1057 ext.

Fax Number (include area code)

(613) 388-2785

Mobile Number (include area code)

E-mail Address

rharris@wm.com

Geo Reference (required)

Description of location	Map Datum	Zone	Accuracy Estimate	Geo-Referencing Method	UTM Easting	UTM Northing
Southwest corner of property	NAD83	18	+/- 100 m	GPS	334808.03	4902407.00
Physical location of front door or main entrance	NAD83	18	+/- 100 m	GPS	335539.02	4902575.62

1 Applicant Information

[Print Form](#) [Clear Form](#) [Save Form](#)

1.3 Applicant Mailing Address

Same as Applicant Physical Address? Yes No

Civic Address – Street Information (civic numbering and street information includes street number, name, type and direction)			Unit Identifier (suite or unit number)
1271 Beechwood Road			
Delivery Designator	Delivery Identifier	Postal Station	
Municipality/Unorganized Township or Territory	Province/State	Country	Postal Code/ZIP Code
Town of Greater Napanee	Ontario	Canada	K7R 3L1

1.4 Statement of the Applicant

I am authorized to prepare and submit this application and to make this certification. I have reviewed the complete application and I have made all inquiries that are necessary to declare to the best of my knowledge, information and belief:

- The information contained in this application is complete and accurate.
- The Technical Contact(s) identified in this application has/have been authorized to prepare certain technical material, and act on behalf of the applicant to discuss this application with the Ministry of the Environment and to provide additional information about this application to the Ministry on request.
- The information provided to the Technical Contact(s) in relation to this application is complete and accurate.

Name of Signing Authority (please print)		Title	
Reid Cleland		Director of Disposal Operations - Ontario	
Telephone Number (include area code & ext.)	Fax Number (include area code)	Mobile Number (include area code)	
(519) 849-5810 ext. <input type="text"/>	(519) 849-5811	(519) 381-6363	
E-mail Address	Signature	Date (yyyy/mm/dd)	
rcleand@wm.com	<input type="text"/>	<input type="text"/>	

1.5 Statement of the Municipality N/A

I, the undersigned hereby declare on behalf of the Municipality, that the Municipality has no objection to the construction of the works in the Municipality.

Name and Title (please print)	Name of Municipality
Signature	Date (yyyy/mm/dd)

2 Project Information

Print Form

Clear Form

Save Form

2.3 Approval Information

Application Initiated by:

- Applicant
 S. 20.18 Order (attach copy)
 Condition of existing approval
 Provincial Officer Order (attach copy)
 Inspection Report (attach copy)
 Other (specify):

Current Environmental Compliance Approvals that may be changed or amended by this application: N/A

Separate list attached? Yes No

Environmental Compliance Approval Number	Date of Issuance (yyyy/mm/dd)
A371203	2012/01/10

Environmental Compliance Approval Number	Date of Issuance (yyyy/mm/dd)

Proposed Environmental Compliance Approvals related to this project: N/A

Separate list attached? Yes No

Project type	Ministry Reference Number (if applicable)	Have submitted	Have not submitted
		<input type="radio"/>	<input type="radio"/>
		<input type="radio"/>	<input type="radio"/>
		<input type="radio"/>	<input type="radio"/>
		<input type="radio"/>	<input type="radio"/>

2.4 Other Approval/Permits for Facility N/A

Separate list attached? Yes No

List all other instruments (approvals or permits) issued by the Ministry of the Environment or applied for under the Environmental Protection Act, Environmental Assessment Act, Ontario Water Resources Act and Safe Drinking Water Act, 2002 and any Environmental Activity and Sector Registrations that are relevant to this application.

Instrument Type	Instrument Number	Approval or Application Date (yyyy/mm/dd)
Industrial Sewage Works	1688-8HZNJG	2012/01/10
Air (LFGCS)	1355-5LRN9N 2003/5/8	
Industrial Sewage Works	4-0129-04-956	1995/01/24
Soil Recycling	A710003	1993/12/20

Instrument Type	Instrument Number	Approval or Application Date (yyyy/mm/dd)

2 Project Information

Print Form

Clear Form

Save Form

2.5 Technical Contacts

Technical Contact 1

Area of Responsibility (check all that apply) Air Noise/Vibration Sewage Waste

Name of Technical Contact

Jeff Armstrong, P.Eng.

Company

GENIVAR Inc.

Telephone Number (include area code & ext.)

(519) 376-7612

ext.

13232

Mobile Number (include area code)

(519) 372-6618

Fax Number (include area code)

(519) 376-8008

E-mail Address

jeff.armstrong@genivar.com

Address Information:

Same as Applicant Mailing Address? Yes No (If no, please provide technical contact address information below.)

Civic Address – Street Information (includes street number, name, type and direction)

1450 1st Avenue West

Unit Identifier (suite or unit number)

Suite 101

Delivery Designator

Delivery Identifier

Postal Station

Municipality/Unorganized Township or Territory

Owen Sound

Province/State

Ontario

Country

Canada

Postal Code/ZIP Code

N4K 6W2

I have been authorized by the applicant to prepare the technical materials for the area(s) of responsibility identified above that are included in the application. I have reviewed those technical materials and I have made all inquiries that are necessary to declare to the best of my knowledge, information and belief:

- The technical materials contained in this application in respect of the area(s) of responsibility identified above are complete and accurate.
- I have the relevant education and experience necessary to provide this certification.

Signature

Date (yyyy/mm/dd)

--	--

2 Project Information

[Print Form](#) [Clear Form](#) [Save Form](#)

Technical Contact 2 N/A 

Area of Responsibility (check all that apply) Air Noise/Vibration Sewage Waste

Name of Technical Contact: Company:

Telephone Number (include area code & ext.): ext. Mobile Number (include area code): Fax Number (include area code): E-mail Address:

Address Information: 

Same as Applicant Mailing Address? Yes No (If no, please provide technical contact address information below.)

Civic Address – Street Information (includes street number, name, type and direction): Unit Identifier (suite or unit number):

Delivery Designator: Delivery Identifier: Postal Station:

Municipality/Unorganized Township or Territory: Province/State: Country: Postal Code/ZIP Code:

I have been authorized by the applicant to prepare the technical materials for the area(s) of responsibility identified above that are included in the application. I have reviewed those technical materials and I have made all inquiries that are necessary to declare to the best of my knowledge, information and belief:

- The technical materials contained in this application in respect of the area(s) of responsibility identified above are complete and accurate.
- I have the relevant education and experience necessary to provide this certification.

Signature: Date (yyyy/mm/dd):

2 Project Information

[Print Form](#)

[Clear Form](#)

[Save Form](#)

Technical Contact 3 N/A 

Area of Responsibility (check all that apply) Air Noise/Vibration Sewage Waste

Name of Technical Contact Company

Telephone Number (include area code & ext.) ext. Mobile Number (include area code) Fax Number (include area code) E-mail Address

Address Information: 

Same as Applicant Mailing Address? Yes No (If no, please provide technical contact address information below.)

Civic Address – Street Information (includes street number, name, type and direction) Unit Identifier (suite or unit number)

Delivery Designator Delivery Identifier Postal Station

Municipality/Unorganized Township or Territory Province/State Country Postal Code/ZIP Code

I have been authorized by the applicant to prepare the technical materials for the area(s) of responsibility identified above that are included in the application. I have reviewed those technical materials and I have made all inquiries that are necessary to declare to the best of my knowledge, information and belief:

- The technical materials contained in this application in respect of the area(s) of responsibility identified above are complete and accurate.
- I have the relevant education and experience necessary to provide this certification.

Signature Date (yyyy/mm/dd)

2 Project Information

[Print Form](#)

[Clear Form](#)

[Save Form](#)

Technical Contact 4 N/A 

Area of Responsibility (check all that apply) Air Noise/Vibration Sewage Waste

Name of Technical Contact	Company
<input type="text"/>	<input type="text"/>

Telephone Number (include area code & ext.)	Mobile Number (include area code)	Fax Number (include area code)	E-mail Address
<input type="text"/> ext. <input type="text"/>	<input type="text"/>	<input type="text"/>	<input type="text"/>

Address Information: 

Same as Applicant Mailing Address? Yes No (If no, please provide technical contact address information below.)

Civic Address – Street Information (includes street number, name, type and direction)	Unit Identifier (suite or unit number)
<input type="text"/>	<input type="text"/>

Delivery Designator	Delivery Identifier	Postal Station
<input type="text"/>	<input type="text"/>	<input type="text"/>

Municipality/Unorganized Township or Territory	Province/State	Country	Postal Code/ZIP Code
<input type="text"/>	<input type="text"/>	Canada	<input type="text"/>

I have been authorized by the applicant to prepare the technical materials for the area(s) of responsibility identified above that are included in the application. I have reviewed those technical materials and I have made all inquiries that are necessary to declare to the best of my knowledge, information and belief:

- The technical materials contained in this application in respect of the area(s) of responsibility identified above are complete and accurate.
- I have the relevant education and experience necessary to provide this certification.

Signature	Date (yyyy/mm/dd)
<input type="text"/>	<input type="text"/>

Print Form

Clear Form

Save Form

3.1 Environmental Bill of Rights (EBR) Requirements

Is this a proposal for a prescribed instrument under the EBR? Yes No

If yes, is this proposal exempted from the EBR requirements? Yes No

If yes, please check one of the following (Please provide supporting information.)

- This proposal has been considered in a substantially equivalent process of public participation. (EBR, 1993, s.30.)
- This proposal is for an emergency situation. (EBR, 1993, s. 29.)
- This proposal is for an amendment to or revocation of an existing Environmental Compliance Approval that is not environmentally significant. (EBR, 1993, s. 22 (3).)
- This proposal has been subject to or exempted from EAA Requirements or considered in a decision of a tribunal. (EBR, 1993, s. 32.)

3.2 Environmental Assessment Act (EAA) Requirements

Is the proposed undertaking subject to the requirements of the EAA? Yes No

If yes, please check one of the following:

- The undertaking has fulfilled the requirements of the EAA through an exemption provided under:
 - Section _____ of Ontario Regulation No. _____
 - Declaration/Exemption Order Number _____

If Regulation, Declaration Order or Exemption Order does not refer directly to this undertaking, please provide supporting documentation to explain why it applies to this facility.
- The proposed undertaking has fulfilled the requirements of the EAA through the completion of a Class EA process:

Name of Class EA: _____

Schedule/Group/Category (if applicable): _____

If applicable, please submit a copy of the proof of completion (for example, Notice of Completion).

Was the undertaking subject of a Part II Order request(s)? Yes No If yes, please submit a copy of the Director's or Minister's decision letter.
- The proposed undertaking has fulfilled all of the requirements for the EAA through:
 - completion of an Environmental Screening Process pursuant to O. Reg. 101/07 of the EAA
 - completion of an Environmental Screening Process pursuant to O. Reg. 116/01 of the EAA

Was the undertaking subject of an elevation request(s)? Yes No If yes, please submit a copy of the Director's decision letter.
 If an appeal was made of the Director's decision, please also submit a copy of the Minister's decision letter.

 - completion of an Environmental Screening Process pursuant to O. Reg. 231/08 of the EAA

Was the undertaking subject of an objection(s)? Yes No If yes, please submit a copy of the Minister's decision letter.
- The proposed undertaking has fulfilled the requirements of the EAA through the completion of an individual Environmental Assessment.
 Please submit a copy of the signed Notice of Approval.

3

Regulatory Requirements

Print Form

Clear Form

Save Form

3.3 Consultation/Notification

Are there any consultation/notification activities that you have undertaken to fulfill requirements by other legislation or through voluntary efforts?

- Yes No

If yes, please:

- 1) describe the consultation/notification activities below; and
- 2) attach documents describing each of these consultation/notification activities, any changes to the project as a result of these activities and any planned consultation/notification activities in the future.

A letter to neighbouring residents informing them of Waste Management's application to amend the ECA has been delivered by WM staff. A copy of the letter, and a distribution list indicating date of delivery, is provided with this application under Attachment 6.

As per Condition 10.14 of ECA No. A371203, a copy of the application package (minus payment information) has been provided to the Public Liaison Committee, the Town of Greater Napanee, Tyendinaga Township and the Mohawks of the Bay of Quinte.

4 Site Information

Print Form

Clear Form

Save Form

4.1 Site Address or Storage Location

Will the vehicles or equipment be stored at more than one location? Yes No N/A

(If yes, please enter all vehicle or equipment storage locations below and attach separate list, as necessary.)

Same as Applicant Physical Address? Yes No

Primary Civic Address – Street Information (includes street number, name, type and direction) Unit Identifier (suite or unit number)

1271 Beechwood Road	
Additional Civic Addresses Separate list attached? <input type="radio"/> Yes <input type="radio"/> No	Unit Identifier (suite or unit number)

Primary Survey Address

Lot	Concession	Part	Reference Plan

Additional Survey Addresses Separate list attached? Yes No

Lot	Concession	Part	Reference Plan

Municipality/Unorganized Township or Territory	Upper Tier/District	Province/State	Country	Postal Code/ZIP Code
Town of Greater Napanee		Ontario	Canada	K7R 3L1

Non-address Information (includes any additional information to clarify the physical location)

Same as Applicant Physical Geo Reference? Yes No **Geo Reference (required)**

Description of location	Map Datum	Zone	Accuracy Estimate	Geo-Referencing Method	UTM Easting	UTM Northing
Southwest corner of property	NAD83	18	+/- 100 m	GPS	334808.03	4902407.00
Physical location of front door or main entrance	NAD83	18	+/- 100 m	GPS	335539.02	4902575.62

4 Site Information

[Print Form](#) [Clear Form](#) [Save Form](#)

4.2 Site or Storage Location Information

Site Name	Days and Hours of Operation	Ministry of the Environment District Office 
<input type="text" value="Richmond Landfill"/>	<input type="text" value="Monday to Friday 8 a.m. to 5 p.m., Saturday 8 a.m. to 1"/>	<input type="text" value="Kingston District Office"/>

Is the site (property) that is the subject of this application owned by the applicant?
If no, please include the owner's name, address and a signed document indicating that the applicant has the authority to install and operate the proposed activity, or store vehicles or equipment on the land. Yes No

Is the applicant the operating authority of the site that is the subject of this application?
If no, please include the operating authority name, address and phone number. Yes No

Is the site located in an area of development control as defined by the Niagara Escarpment Planning & Development Act (NEPDA)?
If yes, please attach a copy of the NEPDA permit for proposed activity. Yes No

Is the site within an area covered by the Oak Ridges Moraine Conservation Plan?
If yes, please attach proof of municipal planning approval for the proposed activity/work (for example, zoning by-law, letter from municipality, etc.). Yes No

4.3 Site Zoning and Classification N/A

Current Land Use	Official Plan Designation	Current Zoning (Please attach zoning map, if available.)
<input type="text" value="Landfill"/>	<input type="text" value="Waste Management"/>	<input type="text" value="Waste Management"/>

Adjacent Land Use (select all that apply)

<input type="checkbox"/> Industrial	<input checked="" type="checkbox"/> Commercial	<input checked="" type="checkbox"/> Residential
<input checked="" type="checkbox"/> Agricultural	<input type="checkbox"/> Recreational	<input type="checkbox"/> Other (specify):

Adjacent Land Zoning

Does the current zoning permit the proposed activity?
 Yes No

Does the applicant have correspondence from the municipality to confirm that the current zoning of the property permits the proposed use?
 Yes No If yes, please attach correspondence from the municipality.

Does the official plan designation support the proposed activity?
 Yes No N/A

4 Site Information

[Print Form](#)

[Clear Form](#)

[Save Form](#)

4.4 Point of Entry into Ontario (for waste management system vehicles that are stored at an address outside of Ontario) N/A

City in closest proximity to the point of entry	Description of Point of Entry

4.5 Source Protection/Drinking Water Threats (sewage or waste disposal site applications only) N/A

Check the source protection area(s) where the activity is/will be located:

- | | | | |
|---|---|--|---|
| <input type="checkbox"/> Ausable Bayfield | <input type="checkbox"/> Grand River | <input type="checkbox"/> Raisin Region | <input type="checkbox"/> Lower Thames Valley |
| <input type="checkbox"/> Maitland Valley | <input type="checkbox"/> Kettle Creek | <input type="checkbox"/> South Nation | <input type="checkbox"/> St. Clair Region |
| <input type="checkbox"/> Cataraqui Region | <input type="checkbox"/> Long Point | <input type="checkbox"/> Grey Sauble | <input type="checkbox"/> Upper Thames River |
| <input type="checkbox"/> Central Lake Ontario | <input type="checkbox"/> Lakehead | <input type="checkbox"/> Northern Bruce Peninsula | <input type="checkbox"/> Crowe Valley |
| <input type="checkbox"/> Credit Valley | <input type="checkbox"/> Mattagami | <input type="checkbox"/> Saugeen Valley | <input type="checkbox"/> Ganaraska |
| <input type="checkbox"/> Toronto and Region | <input type="checkbox"/> Mississippi Valley | <input type="checkbox"/> Sault Ste. Marie | <input type="checkbox"/> Kawartha-Haliburton |
| <input type="checkbox"/> Essex | <input type="checkbox"/> Rideau Valley | <input type="checkbox"/> Lake Simcoe & Couchiching/Black River | <input type="checkbox"/> Lower Trent |
| <input type="checkbox"/> Halton | <input type="checkbox"/> Niagara | <input type="checkbox"/> Nottawasaga Valley | <input type="checkbox"/> Otonabee-Peterborough |
| <input type="checkbox"/> Hamilton | <input type="checkbox"/> North Bay Mattawa | <input type="checkbox"/> Severn Sound | <input type="checkbox"/> Outside a source protection area |
| <input type="checkbox"/> Catfish Creek | <input checked="" type="checkbox"/> Quinte | <input type="checkbox"/> Sudbury | |

Is the proposed activity located or planned to be located in a vulnerable area identified in a local assessment report source protection plan under the Clean Water Act, 2006?

Yes No

If yes, what is/are the vulnerable area(s)/zone(s)?

- | | |
|---|---|
| <input type="checkbox"/> Wellhead Protection Areas | <input type="checkbox"/> Surface Water Intake Protection Zones |
| <input type="checkbox"/> Highly Vulnerable Aquifers | <input type="checkbox"/> Significant Groundwater Recharge Areas |

Is the activity being applied for identified as a significant drinking water threat in the assessment report for the local source protection area? 

Yes No

4 Site Information

Print Form

Clear Form

Save Form

4.6 Receiver of Effluent Discharge (sewage applications only) N/A

Intermediate Receiver Name

Watershed Name

- Surface Water Groundwater Other (specify):

Has the facility received local Conservation Authority clearance? (for stormwater management facility discharging to the natural environment)
 Yes N/A If yes, please include a copy of the Conservation Authority clearance.

Final Receivers N/A

Will the proposed activity discharge sewage to any of the following critical receivers?

- Lake Simcoe Rideau River Detroit River Other (specify):
 Great Lakes Rouge River Bay of Quinte

Is the receiver a Policy 2 receiver? Yes No

Do you have a Policy 2 deviation approval from the directors? Yes No If yes, please attach a copy of the Director's approval.

Print Form

Clear Form

Save Form

5.1 Air N/A  IF YOUR APPLICATION DOES NOT HAVE AIR EMISSIONS PLEASE PROCEED TO SECTION 5.2

5.1.1 Summary of Equipment that Discharges Contaminants to the Air 

(√)	Description	Number of Pieces of Equipment
<input type="checkbox"/>	Combustion equipment that uses natural gas, propane, no. 2 oil, landfill gas or sewage treatment gas for fuel for the purpose of providing comfort heating or emergency power, producing hot water or steam, or heating material in a system that does not discharge to the atmosphere (Total Heat input of all units ≤ 50,000,000 kJ/hr)	N/A
<input type="checkbox"/>	Storage tanks	N/A
<input type="checkbox"/>	Welding operations that use a maximum of 10 kilograms of welding rod per hour	N/A
<input type="checkbox"/>	Combustion equipment that uses waste-derived fuel for the purpose of providing comfort heating, burning ≤ 15 litres per hour	
<input type="checkbox"/>	Heat cleaning ovens used for parts cleaning and associated parts washers or degreasing equipment, other than solvent degreasing equipment	
<input type="checkbox"/>	Cooling towers	
<input type="checkbox"/>	Equipment used to control emissions of contaminants, other than a fume incinerator	
<input type="checkbox"/>	Laboratory fume hoods	
<input type="checkbox"/>	Paint spray booths and associated equipment that have a design capacity of up to 8 litres per hour of paint	
<input type="checkbox"/>	Grain dryers	
<input type="checkbox"/>	Any other equipment not listed above with a flow rate of less than or equal to 1.5 m ³ per second	
<input type="checkbox"/>	Any other equipment not listed above with a flow rate of greater than 1.5 m ³ per second	
<input type="checkbox"/>	Equipment that is subject to an Environmental Compliance Approval, and from which there is no proposed increase in the discharge of any contaminant that was previously reviewed by the Director.	N/A

5.1.2 Emission Summary and Dispersion Modelling (ESDM) Report 

Is the review of an existing, approved ESDM required as part of this proposed application? Yes No

If yes, identify the number of emission sources described in the existing ESDM Report that emit contaminants in common with the sources forming the subject of the application (if none, enter zero).

Have all of these emission sources been described in an ESDM Report that was previously reviewed as part of an application for an existing Environmental Compliance Approval? Yes No

[Print Form](#)

[Clear Form](#)

[Save Form](#)

5.1.3 O. Reg. 419/05 Requirements

Which of the following sections of O. Reg. 419/05 applies to the facility?

s.19 (Schedule 2) s.20 (Schedule 3) Does not apply. Please indicate reason:

Has an instrument under O. Reg. 419/05 been issued? Yes No

If yes, what type(s) of instruments (including any notices, orders or approvals) has (have) been issued? (select all that apply)

- | | |
|---|---|
| <input type="checkbox"/> ss. 4(2) Adjacent Properties | <input type="checkbox"/> ss. 20(4) Speed-up Request |
| <input type="checkbox"/> ss. 7(1) Specified Dispersion Models | <input type="checkbox"/> ss. 20(5) Speed-up Order |
| <input type="checkbox"/> ss. 8(2) Negligible Sources | <input type="checkbox"/> s. 35 Site-specific Standard |
| <input type="checkbox"/> ss. 10(2) Operating Conditions | <input type="checkbox"/> ss. 35(14) Site-specific Standard Order |
| <input type="checkbox"/> ss. 11(2) Refined Emission Rates | <input type="checkbox"/> ss. 39(3) Technical Standard Registration (Industry Standard) |
| <input type="checkbox"/> ss. 13.1 Value of Dispersion Modeling Parameters | <input type="checkbox"/> ss. 39(4) Technical Standard Registration (Equipment Standard) |
| <input type="checkbox"/> ss. 13(1) Meteorological Data | |
| <input type="checkbox"/> ss. 14(6) Area of Modelling Coverage | |
| <input type="checkbox"/> Other (list all that have been issued): | |

Is an instrument under O. Reg. 419/05 being requested as part of this application? Yes No

If yes, what type(s) of notice, order or approval is (are) being requested?

- | | |
|---|---|
| <input type="checkbox"/> ss. 7(1) Specified Dispersion Models | <input type="checkbox"/> ss. 14(6) Area of Modelling Coverage |
| <input type="checkbox"/> ss. 8(2) Negligible Sources | <input type="checkbox"/> ss. 20(4) Speed-up Request |
| <input type="checkbox"/> ss. 10(2) Operating Conditions | <input type="checkbox"/> s. 32 Request for a Site-specific Standard Order |
| <input type="checkbox"/> ss. 11(2) Refined Emission Rates | <input type="checkbox"/> ss. 39(1)(a) Application for Technical Standard Registration (Industry Standard) |
| <input type="checkbox"/> ss. 13(1) Meteorological Data | <input type="checkbox"/> ss. 39(1)(b) Application for Technical Standard Registration (Equipment Standard). |
| <input type="checkbox"/> Other (list all that have been requested): | |

Please attach the form(s) requesting the notice(s) and/or order(s) and any additional supporting information.

Has an s.30 Upper Risk Threshold (Schedule 6) been exceeded? If yes, please include additional supporting information. Yes No

Is the facility located in a multi-tenant building? If yes, additional information may be requested. Yes No

Are all of the contaminants to which the application relates represented in the Ministry of the Environment publication titled "Summary of Standards and Guidelines to support Ontario Regulation 419: Air Pollution – Local Air Quality" or have they been screened out based on the publication titled "Jurisdictional Screening Level (JSL) List, A Screening Tool for Ontario Regulation 419: Air Pollution – Local Air Quality"? (If no, please attach Supporting Information for a Maximum Ground Level Concentration Acceptability Request for Compounds with no Ministry POI Limit – Supplement to Application for Approval, EPA S.9 (PIBS 4872)). Yes No

5

Facility Information

Contents | General Information and Instructions | Application Summary | 1 Applicant Information | 2 Project Information | 3 Regulatory Requirements | 4 Site Information | **5 Facility Information** | 6 Supporting Documentation and Technical Requirements | 7 Payment Information

Print Form

Clear Form

Save Form

5.2 Noise N/A IF YOUR APPLICATION DOES NOT HAVE NOISE EMISSIONS, PLEASE PROCEED TO SECTION 5.3.

5.2.1 Noise Assessment

Have you completed an **Acoustic Assessment Report (AAR)** or **Abbreviated Acoustic Assessment Report (A-AAR)**? Yes No

If yes, please indicate the report you have completed:

AAR Please attach the Acoustic Assessment Report.

Does the AAR show that applicable limits are met? Yes No

If no, please attach the Acoustic Assessment Report including the Noise Abatement Action Plan.

A-AAR Please attach the Abbreviated Acoustic Assessment Report.

Does the A-AAR show that applicable limits are met? Yes No

Note that certain conditions must be met before using the A-AAR and that the A-AAR must show that the applicable limits are met otherwise an AAR may be required.

If no, is the application eligible for **Primary or Secondary Noise Screening**? Yes No

Note that if you are not eligible for either of the screenings, you must submit either an AAR or A-AAR.

If yes, is your proposed activity described with one of the **NAICS codes that are eligible for the Primary Noise Screening**? Yes No

If yes, is the actual separation distance between the facility and the noise sensitive point of reception (POR) greater than the minimum required separation distance calculated from the **Primary Noise Screening**? Yes No

If yes, please attach the Primary Noise Screening form and supporting documentation.

Note that if the Primary Noise Screening is not successful then you may attempt to proceed with the secondary noise screening.

If no, does the **Secondary Noise Screening report show that the applicable sound level limits are met**? Yes No

If yes, please attach the Secondary Noise Screening Report and supporting documentation.

Note that if you cannot demonstrate that the applicable sound level limits are met then you must submit either an AAR or A-AAR.

5 Facility Information

Print Form

Clear Form

Save Form

5.2.2 Equipment Subject to Noise Review

(√)	Description	Number of Pieces of Equipment
<input type="checkbox"/>	Arc Furnaces	
<input type="checkbox"/>	Asphalt Plants	
<input type="checkbox"/>	Blow-down Devices	
<input type="checkbox"/>	Co-generation Facilities	
<input type="checkbox"/>	Crushing Operations	
<input type="checkbox"/>	Flares	
<input type="checkbox"/>	Gas Turbines	
<input type="checkbox"/>	Pressure Blowers or Large Induced Draft Fans (flow rate > 47m ³ /second or static pressure > 1.25 kilopascals)	
<input type="checkbox"/>	Any other equipment not listed above that has not previously been reviewed by the Director in connection with an application for an Environmental Compliance Approval with respect to the facility	
<input type="checkbox"/>	Any other equipment not listed above that is identical to equipment for which a noise assessment was previously reviewed by the Director in connection with an application for an Environmental Compliance Approval with respect to the facility	

5

Facility Information

Print Form

Clear Form

Save Form

5.3 Sewage Works N/A IF YOUR APPLICATION DOES NOT CONTAIN SEWAGE WORKS PLEASE PROCEED TO SECTION 5.4

5.3.1 Facility Type – Sewage Works

Select the type of facility that is the subject of the application (select all that apply).

Sewage Treatment Plant (STP)

Further information:

Primary

Secondary

Tertiary

Receives septage

Constructed/Engineered Wetlands

On-site system

Lagoons (check all that apply below)

Septage

Municipal

Other (specify):

Municipal or private facility

Category: New 1 2 3 4

Please indicate the maximum design capacity of the municipal or private sewage treatment plant:

≤ 4,550 m³/day

> 4,550 m³/day

Facility for the treatment of leachate

Category: New 1 2 3 4

Facility for the treatment of industrial process wastewater

Category: New 1 2 3 4

Facility for the disposal of non-contact cooling water

Subsurface disposal

Please indicate the design capacity of the subsurface disposal:

≤ 15 m³/day

> 15 m³/day and < 50 m³/day

> 50 m³/day

Stormwater Management Facility

Category: New 1 2 3 4

Wet Pond

Dry Pond

Other (specify):

For the following, you must complete and attach the relevant sections of the pipe data form:

Storm Sewers

Ditches

Combined Sewers

Forcemains

Sanitary Sewers

Pumping Station

Is a Hydrogeological Assessment required? Yes No (If yes, please attach the hydrogeological assessment.)

Is a review of effluent criteria assessment for stormwater management, cooling water or soil remediation facilities required? Yes No
(If yes, please attach the final effluent criteria accepted by the Regional Office of the Ministry.)

Is a review of effluent criteria assessment for municipal or private sewage, industrial process wastewater or leachate treatment plant required? Yes No
(If yes, please attach the final effluent criteria accepted by the Regional Office of the Ministry.)

5 Facility Information

Print Form

Clear Form

Save Form

5.3.2 Servicing

The works will provide sewage servicing for (select all that apply):

- Residential
 Subdivision
 Condominium
 Institutional
 Other (specify):

Is there a Municipal Responsibility Agreement in place?
 Yes
 No
 N/A
 If yes, please attach a copy of the Municipal Responsibility Agreement.

- Commercial
 Hotel, Motel, Inn
 Resort
 Restaurant
 Campground, Park
 Shopping Malls
 Highway Service Station/Gas Bars
 Rental Cabins
 Other (specify):

Industrial Describe:

5.3.3 Sewage Servicing for Waste Disposal/Landfill Sites

Does/Will the sewage treatment facility receive waste disposal/landfill site leachate?
 Yes
 No
 If yes, please identify the site(s) below.

Name of Site Contributing Leachate	Environmental Compliance Approval Number	Volume of leachate (m ³)
1.		
2.		
3.		
4.		
5.		

5 Facility Information

5.4.2 Waste Transfer/Processing/Composting – Complete this information if waste transfer and/or processing and/or composting take(s) place at this facility N/A

Waste Types to be Transferred or Processed	Design Capacity
<input type="checkbox"/> Hazardous waste or liquid industrial waste	<input type="radio"/> ≤ 100 tonnes per day <input type="radio"/> > 100 tonnes per day
<input checked="" type="checkbox"/> Waste other than hazardous waste and liquid industrial waste	<input checked="" type="radio"/> ≤ 100 tonnes per day <input type="radio"/> > 100 tonnes per day

Change to Operations		
<input type="radio"/> No Change Proposed	<input checked="" type="radio"/> Change does not require fundamental design review	<input type="radio"/> Change requires fundamental design review

Liquid Waste								
Maximum Storage Capacity (m³)			Maximum Residual for Final Disposal (m³)					
Hazardous	Liquid Industrial	Other Liquid Waste	Hazardous		Liquid Industrial		Other Liquid Waste	
			Daily	Annually	Daily	Annually	Daily	Annually
		0.00					0.00	0.00

Solid Waste					
Maximum Storage Capacity (tonnes)		Maximum Residual for Final Disposal (tonnes)			
Hazardous	Non-hazardous	Hazardous		Non-hazardous	
		Daily	Annually	Daily	Annually
	50.00			50.00	15600.00

Maximum Amount of Waste to be Received Daily					
Liquid (m³)			Solid (tonnes)		
Hazardous	Liquid Industrial	Other Liquid Waste	Hazardous		Non-hazardous
			Daily	Annually	Daily
		0.00			50.00

5 Facility Information

Print Form

Clear Form

Save Form

5.4.3 Thermal Treatment Facility – Complete this information if thermal treatment takes place at this facility N/A

Waste Type for Thermal Treatment	Design Capacity
<input type="checkbox"/> Hazardous waste or liquid industrial waste	<input type="radio"/> ≤ 100 tonnes per day <input type="radio"/> > 100 tonnes per day
<input type="checkbox"/> Waste other than hazardous waste and liquid industrial waste	<input type="radio"/> ≤ 100 tonnes per day <input type="radio"/> > 100 tonnes per day

Change to Operations
<input type="radio"/> No Change Proposed <input type="radio"/> Change does not require fundamental design review <input type="radio"/> Change requires fundamental design review

Liquid Waste								
Maximum Storage Capacity (m³)			Maximum Residual for Final Disposal (m³)					
Hazardous	Liquid Industrial	Other Liquid Waste	Hazardous		Liquid Industrial		Other Liquid Waste	
			Daily	Annually	Daily	Annually	Daily	Annually

Solid Waste					
Maximum Storage Capacity (tonnes)		Maximum Residual for Final Disposal (tonnes)			
Hazardous	Non-hazardous	Hazardous		Non-hazardous	
		Daily	Annually	Daily	Annually

Maximum Amount of Waste to be Received Daily					
Liquid (m³)			Solid (tonnes)		
Hazardous	Liquid Industrial	Other Liquid Waste	Hazardous	Non-hazardous	

Maximum Daily Feed Rate (tonnes/m³)			
Hazardous Waste (tonnes)	Non-hazardous Waste (tonnes)	Liquid Industrial Waste (m³)	Other Liquid Waste (m³)

5 Facility Information

Print Form

Clear Form

Save Form

5.4.4 Landfill Site – Complete this information if this facility operates as a landfill site N/A

Waste Types to be accepted at the Landfill	Design Capacity		
<input type="checkbox"/> Hazardous waste or liquid industrial waste	<input type="radio"/> ≤ 40,000 m ³	<input type="radio"/> > 40,000 m ³ ≤ 3 million m ³	<input type="radio"/> > 3 million m ³
<input type="checkbox"/> Waste is only uncontaminated tree stumps, leaves, branches, concrete and rocks	<input type="radio"/> ≤ 40,000 m ³	<input type="radio"/> > 40,000 m ³ ≤ 3 million m ³	<input type="radio"/> > 3 million m ³
<input checked="" type="checkbox"/> Waste other than hazardous waste and liquid industrial waste, other than uncontaminated tree stumps, leaves, branches, concrete and rocks.	<input checked="" type="radio"/> ≤ 40,000 m ³	<input checked="" type="radio"/> > 40,000 m ³ ≤ 3 million m ³	<input type="radio"/> > 3 million m ³

Change to Operations		
<input checked="" type="radio"/> No Change Proposed	<input type="radio"/> Change does not require fundamental design review or hydrogeological assessment	<input type="radio"/> Change requires fundamental design review or hydrogeological assessment

Maximum Landfilling Capacity (m ³)			
Hazardous Waste	Non-hazardous Waste	Liquid Industrial Waste	Other Liquid Waste
	2842700.00		0.00

Maximum Amount of Waste to be Received							
Hazardous Waste (tonnes)		Non-hazardous Waste (tonnes)		Liquid Industrial Waste (m ³)		Other Liquid Waste (m ³)	
Daily	Annually	Daily	Annually	Daily	Annually	Daily	Annually
		400.00	125000.00			0.00	0.00

Landfill Information				
Area to be Landfilled (hectares)	Total Site Area including Buffer Area (hectares)	Estimated Date of Closure (yyyy/mm/dd)	Population Served	Control Types (select all that apply)
16.20	138.00	2011/06/30	14000000.00	<input checked="" type="checkbox"/> Leachate Collected and Treated Off-site <input type="checkbox"/> Leachate Collected and Treated On-site <input checked="" type="checkbox"/> Landfill Gas Collected and Flared <input type="checkbox"/> Landfill Gas Collected for Energy Generation <input type="checkbox"/> Other (describe):

5

Facility Information

Contents | General Information and Instructions | Application Summary | 1 Applicant Information | 2 Project Information | 3 Regulatory Requirements | 4 Site Information | **5 Facility Information** | 6 Supporting Documentation and Technical Requirements | 7 Payment Information

Print Form

Clear Form

Save Form

5.5 Waste Management Systems (Except Mobile Waste Processing) N/A

IF YOUR APPLICATION IS NOT FOR A WASTE MANAGEMENT SYSTEM PLEASE PROCEED TO SECTION 5.7.

5.5.1 Fleet List (all vehicles and equipment to be used in the operation of the Waste Management System)

Separate list attached? Yes No

Year	Make	Model	Vehicle Identification Number (VIN)	Licence Plate Number	Province/State

5.5.2 Vehicle Information

Are all the vehicles to be used owned by the applicant? Yes No

If no, please include additional information about ownership arrangements for each vehicle not owned by the applicant.

Has a minimum of \$1,000,000.00 liability insurance been obtained for all vehicles for which it is required? Yes No

Describe any additional insurances that are held (for example, environmental impairment liability insurance).

5 Facility Information

[Print Form](#)

[Clear Form](#)

[Save Form](#)

5.5.3 General Waste Management System N/A

Type(s) of Waste to be Transported by the General Waste Management System (select all that apply)

Subject:

- Hazardous Waste
- Liquid Industrial Waste

Non-subject:

- Municipal (non-hazardous)
- Other Liquid Waste

Non-subject Categories to be Transported by the General Waste Management System (select all that apply)

- All Categories
- Domestic Sources
- Commercial
- (Non-subject) Solid Industrial
- Asbestos Waste in Bulk
- Blue Box Materials
- Leaf/Yard Waste
- Wood Waste
- Spill Cleanup Material
- Contaminated Soil
- Dewatered Catch Basin Clean-out Material
- Tires
- Waste Wash Water
- Processed Organics (not for land application)
- Grease Trap Waste
- Waste from Food Processing/Preparation Operations
- Others (specify):

Subject Waste Categories to be Transported by the General Waste Management System

Separate list attached? Yes No

Hazardous Waste / Liquid Industrial Waste								
Class Code	Class Code	Class Code	Class Code	Class Code	Class Code	Class Code	Class Code	Class Code

- All drivers are/will be trained in accordance with O. Reg. 347 and all pertinent environmental legislation.
- Each vehicle used to transport a specific subject waste class is suitable for that waste transportation in order to protect the health and safety of the public and the natural environment.

Note: For transporters of pathological waste and PCBs (waste classes 243 and 312) Operations Manual and Driver Training Manual must also be attached and Financial Assurance must be provided.

5 Facility Information

[Print Form](#)

[Clear Form](#)

[Save Form](#)

General Waste Management System – Disposal Site Information

What is the Final Destination of Waste to be Transported by the General Waste Management System? (select all that apply)

- A disposal site in Ontario approved by the Ministry of the Environment
- Disposal sites outside of Ontario approved by another regulatory agency

List the destination province(s)/state(s):

5.5.4 Soil Conditioner Waste Management System N/A

(includes non-agricultural source material (NASM) that is waste and processed organic waste (biosolids) destined for land application only)

Has the applicant received recommendation from Biosolids Utilization Committee (BUC) for land application of processed organic waste (biosolids) or NASM?

- Yes If yes, please provide a copy of the BUC recommendation.
- No If no, please clarify:

Spreading equipment (land application only)

Separate list attached? Yes No

Equipment Type	Make & Model	Description

5 Facility Information

[Print Form](#)

[Clear Form](#)

[Save Form](#)

Method of system operation (land application only)

Estimated quantity to be handled on an annual basis (cubic metres/litres/tonnes):

Please describe the loading procedures:

Please describe the spreading methods:

Please describe the storage facilities (tanks, lagoons, etc.):

Soil Conditioner Waste Management System – Land Application Sites

What is the final destination of waste to be transported by the soil conditioner waste management system? (must include for land application only)

- Non-agricultural land
 Agricultural land
 Both agricultural and non-agricultural land

5.5.5 Hauled Sewage (Septage) Waste Management System N/A

Type(s) of hauled sewage (septage) to be transported

- Portable toilet waste
 Septic tank waste
 Holding tank waste
 Other (specify):

Spreading Equipment (land application only)

Separate list attached? Yes No

Equipment Type	Make & Model	Description

5 Facility Information

Print Form

Clear Form

Save Form

Does this system include in-transit storage? Yes No 

If yes:

a) What is the duration of storage? Please specify (Maximum period of in-transit storage should not exceed more than two weeks):

b) Is the storage tank a prefabricated tank with the capacity < 100,000 L, designed and constructed in accordance with a Class 5 Sewage System under the Ontario Building Code or CAN/CSA B66-05?

Yes No If no, please provide a copy of the design of the storage tank signed and dated by a professional engineer.

Does this system include in-transit processing? Yes No 

If yes:

a) Location of in-transit processing:

In Vehicle In-storage Tank

b) Describe the method of in-transit processing:

Does this system use barge/boat to transport hauled sewage (septage)? Yes No 

If yes,

a) Has a minimum of \$1,000,000.00 liability insurance been obtained for the barge/boat for which it is required?

Yes No

b) Does the barge/boat have an engine of 10 horsepower (hp) or more, for which a commercial vessel licence is required from Transport Canada?

Yes No If yes, please include a copy of the commercial vessel licence.

Note: For in-transit storage or processing the applicant must include with the application the consent of the landowner, if the landowner is different than the applicant. A financial assurance estimate must be provided by applicants using in-transit storage or using in-transit processing where processing is conducted in the in-transit storage tanks.

5 Facility Information

Print Form

Clear Form

Save Form

Hauled Sewage (Septage) Waste Management System – Land Application Sites N/A

List the Environmental Compliance Approval Number(s) of all disposal site(s) approved by the Ministry of the Environment for land application of hauled sewage in association with this waste management system.

Instrument Type	Instrument Number	Approval or Application Date (yyyy/mm/dd)

Instrument Type	Instrument Number	Approval or Application Date (yyyy/mm/dd)

5

Facility Information

Print Form

Clear Form

Save Form

5.6 Waste Management System – Mobile Waste Processing N/A

5.6.1 Mobile Waste Management System Process and Equipment Description

Type(s) of Waste to be Processed (select all that apply)

Subject:

- Hazardous Waste
- Liquid Industrial Waste

Non-subject:

- Municipal (non-hazardous)
- Other Liquid Waste

Number of Units	Type of Waste to be Processed by the Unit(s)	Financial Assurance (per unit)	Financial Assurance Required
	Non-hazardous Solid Waste	\$5,000	
	Hazardous Waste	\$20,000	
	Liquid Industrial Waste	\$20,000	
	Other Liquid Waste	\$20,000	
	Multiple Types of Waste from the Categories Above	\$20,000	
Total Financial Assurance			\$0

Municipal (non-hazardous) Waste Categories to be Processed (select all that apply)

- Contaminated Soil at Cleanup Site
- Wood Waste
- Construction & Demolition Waste
- Asbestos Waste
- Tires
- Domestic Waste
- Other (specify):

Other Liquid Waste Categories to be Processed (select all that apply)

- Hauled Sewage
- Waste from Food Processing/Preparation Operations
- Processed Organic
- Other (specify):

Hazardous/Liquid Industrial Waste Types to be Processed							
Class Code	Class Code	Class Code	Class Code	Class Code	Class Code	Class Code	Class Code

5 Facility Information

[Print Form](#)

[Clear Form](#)

[Save Form](#)

5.6.2 Equipment Information – Please attach a separate list if more space is required.

Separate list attached? Yes No

Unit No.	Unit Type	Process Description	Equipment List				
			Equipment Type	Make	Model	Serial Number	Equipment Capacity (including unit of measurement)
Unit 1							
Unit 2							
Unit 3							
Unit 4							

5 Facility Information

Contents | General Information and Instructions | Application Summary | 1 Applicant Information | 2 Project Information | 3 Regulatory Requirements | 4 Site Information | **5 Facility Information** | 6 Supporting Documentation and Technical Requirements | 7 Payment Information

[Print Form](#)

[Clear Form](#)

[Save Form](#)

5.7 Cleanup of Contaminated Sites N/A

IF YOUR APPLICATION IS NOT FOR A CLEANUP OF A CONTAMINATED SITE PLEASE PROCEED TO SECTION 6.

Type of cleanup:

- In-situ
- Ex-situ
- Both

Contaminated media to be treated:

- Groundwater
- Surface water
- Sediment
- Soil

Waste Type:

Subject:

- Hazardous Waste
- Liquid Industrial Waste

Non-subject:

- Municipal (non-hazardous)
- Other Liquid Waste

Type of discharge:

- Air
- Groundwater
- Storm or sanitary
- Surface water
- Noise

Print Form

Clear Form

Save Form

6.1 General — THIS IS A LIST OF SUPPORTING INFORMATION TO THIS APPLICATION AND IS SUBJECT TO THE FIPPA AND EBR.

Attachment	Attached	If no, provide explanation, (include referenced attachment if more space is required for rationale)	Confidential* (√)
<input checked="" type="checkbox"/> Proof of legal name	<input checked="" type="radio"/> Yes <input type="radio"/> No		<input type="checkbox"/>
Enhanced EBR description	<input type="radio"/> Yes <input type="radio"/> No		<input type="checkbox"/>
Provincial Officer Notice	<input type="radio"/> Yes <input type="radio"/> No		<input type="checkbox"/>
Inspection Report	<input type="radio"/> Yes <input type="radio"/> No		<input type="checkbox"/>
<input checked="" type="checkbox"/> Detailed project and process description	<input checked="" type="radio"/> Yes <input type="radio"/> No		<input type="checkbox"/>
<input checked="" type="checkbox"/> Pre-application Consultation Record	<input type="radio"/> Yes <input checked="" type="radio"/> No	Not applicable	<input type="checkbox"/>
Legal Survey(s)	<input type="radio"/> Yes <input type="radio"/> No		<input type="checkbox"/>
<input checked="" type="checkbox"/> Site Plan(s)	<input checked="" type="radio"/> Yes <input type="radio"/> No		<input type="checkbox"/>
<input checked="" type="checkbox"/> Scaled area location plan(s) with geo-referencing points identified	<input checked="" type="radio"/> Yes <input type="radio"/> No		<input type="checkbox"/>
<input checked="" type="checkbox"/> Documentation in support of EBR Exception	<input checked="" type="radio"/> Yes <input type="radio"/> No		<input type="checkbox"/>
Proof of Compliance with EAA Requirements	<input type="radio"/> Yes <input type="radio"/> No		<input type="checkbox"/>
<input checked="" type="checkbox"/> Proof of Consultation/Notification	<input checked="" type="radio"/> Yes <input type="radio"/> No		<input type="checkbox"/>
<input checked="" type="checkbox"/> Financial Assurance Estimate	<input type="radio"/> Yes <input checked="" type="radio"/> No	Not applicable	<input type="checkbox"/>
Name, address and consent of land/site owner for the installation and operation of the proposed activity or storage location of equipment or vehicle	<input type="radio"/> Yes <input type="radio"/> No		<input type="checkbox"/>
Name, address and phone number of the Operating Authority	<input type="radio"/> Yes <input type="radio"/> No		<input type="checkbox"/>
Copy of NEPDA Permit	<input type="radio"/> Yes <input type="radio"/> No		<input type="checkbox"/>
Copy/Proof of Municipal Planning Approval (ORMCA, general)	<input type="radio"/> Yes <input type="radio"/> No		<input type="checkbox"/>
Municipal Zoning Confirmation Letter	<input type="radio"/> Yes <input type="radio"/> No		<input type="checkbox"/>
<input checked="" type="checkbox"/> Zoning map	<input type="radio"/> Yes <input checked="" type="radio"/> No	Not applicable	<input type="checkbox"/>
Conservation Authority Clearance	<input type="radio"/> Yes <input type="radio"/> No		<input type="checkbox"/>
Director's approval for Policy 2 Deviation	<input type="radio"/> Yes <input type="radio"/> No		<input type="checkbox"/>
<input checked="" type="checkbox"/> Application Fee	<input checked="" type="radio"/> Yes <input type="radio"/> No		<input type="checkbox"/>



Supporting Documentation and Technical Requirements

Print Form

Clear Form

Save Form

Attachment	Attached	If no, provide explanation, (include referenced attachment if more space is required for rationale)	Confidential* (✓)
<input checked="" type="checkbox"/> A copy of this application has been sent to the Ministry Local District Office	<input checked="" type="radio"/> Yes <input type="radio"/> No		<input type="checkbox"/>
Explanation for confidentiality	<input type="radio"/> Yes <input type="radio"/> No		<input type="checkbox"/>
Other (please describe): <input type="text"/>	<input type="radio"/> Yes <input type="radio"/> No		<input type="checkbox"/>

6.2 Air N/A

Emission Summary and Dispersion Modelling (ESDM) Report prepared in accordance with s.22 and of O. Reg. 419/05 (including signed checklist – PIBS 5357e)	<input type="radio"/> Yes <input type="radio"/> No		<input type="checkbox"/>
Electronic copy of the Dispersion Modelling input and output files prepared in accordance with s.26 of O. Reg. 419/05	<input type="radio"/> Yes <input type="radio"/> No		<input type="checkbox"/>
Supporting Information for a Maximum Ground Level Concentration Acceptability Request for Compounds with no Ministry POI Limit – Supplement to Application for Approval, EPA S.9 (PIBS 4872)	<input type="radio"/> Yes <input type="radio"/> No		<input type="checkbox"/>
Copies of forms requesting O. Reg. 419/05 instruments and supporting documentation	<input type="radio"/> Yes <input type="radio"/> No		<input type="checkbox"/>
Other (please describe): <input type="text"/>	<input type="radio"/> Yes <input type="radio"/> No		<input type="checkbox"/>

6.3 Noise and Vibration N/A

Primary Noise Screening	<input type="radio"/> Yes <input type="radio"/> No		<input type="checkbox"/>
Secondary Noise Screening	<input type="radio"/> Yes <input type="radio"/> No		<input type="checkbox"/>
Abbreviated Acoustic Assessment Report including signed checklist (A-AAR)	<input type="radio"/> Yes <input type="radio"/> No		<input type="checkbox"/>
Acoustic Assessment Report including signed checklist (AAR) (PIBS 5356e)	<input type="radio"/> Yes <input type="radio"/> No		<input type="checkbox"/>
Vibration Assessment report	<input type="radio"/> Yes <input type="radio"/> No		<input type="checkbox"/>

6 Supporting Documentation and Technical Requirements

Contents | General information and instructions | Application Summary | 1 Applicant Information | 2 Project Information | 3 Regulatory Requirements | 4 Site Information | 5 Facility Information | 6 Supporting Documentation and Technical Requirements | 7 Payment Information

Print Form

Clear Form

Save Form

Attachment	Attached	If no, provide explanation, (include referenced attachment if more space is required for rationale)	Confidential* (√)
Noise Abatement Action Plan	<input type="radio"/> Yes <input type="radio"/> No		<input type="checkbox"/>
Other (please describe): <input type="text"/>	<input type="radio"/> Yes <input type="radio"/> No		<input type="checkbox"/>

6.4 Sewage N/A

<input type="checkbox"/> Signed Municipal Responsibility Agreement	<input type="radio"/> Yes <input type="radio"/> No		<input type="checkbox"/>
<input type="checkbox"/> Detailed description of the proposed activities/works	<input type="radio"/> Yes <input type="radio"/> No		<input type="checkbox"/>
<input checked="" type="checkbox"/> Notice of Completion for the Environmental Study Report (ESR)	<input checked="" type="radio"/> Yes <input type="radio"/> No		<input type="checkbox"/>
<input type="checkbox"/> Design Brief	<input type="radio"/> Yes <input type="radio"/> No		<input type="checkbox"/>
<input checked="" type="checkbox"/> Preliminary Engineering Report	<input checked="" type="radio"/> Yes <input type="radio"/> No		<input type="checkbox"/>
<input type="checkbox"/> Final Plans	<input type="radio"/> Yes <input type="radio"/> No		<input type="checkbox"/>
<input type="checkbox"/> Engineering Drawings and Specifications	<input type="radio"/> Yes <input type="radio"/> No		<input type="checkbox"/>
<input type="checkbox"/> Sewage quantity and quality characteristics	<input type="radio"/> Yes <input type="radio"/> No		<input type="checkbox"/>
<input type="checkbox"/> Stormwater Management Report	<input type="radio"/> Yes <input type="radio"/> No		<input type="checkbox"/>
<input type="checkbox"/> Stormwater Management Plan	<input type="radio"/> Yes <input type="radio"/> No		<input type="checkbox"/>
<input type="checkbox"/> Hydrogeological Assessment	<input type="radio"/> Yes <input type="radio"/> No		<input type="checkbox"/>
<input checked="" type="checkbox"/> Environmental Impact Analysis	<input checked="" type="radio"/> Yes <input type="radio"/> No		<input type="checkbox"/>
<input type="checkbox"/> Final effluent criteria accepted by regional office of the Ministry	<input type="radio"/> Yes <input type="radio"/> No		<input type="checkbox"/>
Sewage Works Limited Operational Flexibility Requirements			
<input type="checkbox"/> 1. Engineer's Report	<input type="radio"/> Yes <input type="radio"/> No		<input type="checkbox"/>
<input type="checkbox"/> 2. Declarations	<input type="radio"/> Yes <input type="radio"/> No		<input type="checkbox"/>
<input type="checkbox"/> Pipe Design Data Form	<input type="radio"/> Yes <input type="radio"/> No		<input type="checkbox"/>
Other (please describe): <input type="text"/>	<input type="radio"/> Yes <input type="radio"/> No		<input type="checkbox"/>

6 Supporting Documentation and Technical Requirements

Print Form

Clear Form

Save Form

Attachment	Attached	If no, provide explanation, (include referenced attachment if more space is required for rationale)	Confidential* (√)
------------	----------	--	----------------------

6.5 Waste Disposal Sites N/A

<input checked="" type="checkbox"/> Design and Operations Report	<input checked="" type="radio"/> Yes <input type="radio"/> No		<input type="checkbox"/>
<input checked="" type="checkbox"/> Stormwater Management Report	<input type="radio"/> Yes <input checked="" type="radio"/> No	Not applicable	<input type="checkbox"/>
<input checked="" type="checkbox"/> Hydrogeological Assessment	<input type="radio"/> Yes <input checked="" type="radio"/> No	Not applicable	<input type="checkbox"/>
<input checked="" type="checkbox"/> Assessment of Physical and Water Use Conditions	<input type="radio"/> Yes <input checked="" type="radio"/> No	Not applicable	<input type="checkbox"/>
Waste Limited Operational Flexibility Requirements			
1. Engineer's Report	<input type="radio"/> Yes <input type="radio"/> No		<input type="checkbox"/>
2. Declarations	<input type="radio"/> Yes <input type="radio"/> No		<input type="checkbox"/>
<input checked="" type="checkbox"/> Copy of notification to adjacent landowners	<input checked="" type="radio"/> Yes <input type="radio"/> No		<input type="checkbox"/>
<input checked="" type="checkbox"/> Other (please describe):	<input type="radio"/> Yes <input checked="" type="radio"/> No	See attachment 2	<input type="checkbox"/>

6.6 Waste Management Systems N/A

Proof of vehicle and/or equipment ownerships	<input type="radio"/> Yes <input type="radio"/> No		<input type="checkbox"/>
Complete Fleet List (list of all vehicles, trailers and equipment used)	<input type="radio"/> Yes <input type="radio"/> No		<input type="checkbox"/>
Copy of the Liability insurance for all vehicles for which insurance is required	<input type="radio"/> Yes <input type="radio"/> No		<input type="checkbox"/>
Copy of BUC recommendation	<input type="radio"/> Yes <input type="radio"/> No		<input type="checkbox"/>
Copy of the storage tank design	<input type="radio"/> Yes <input type="radio"/> No		<input type="checkbox"/>
Copy of commercial vehicle licence	<input type="radio"/> Yes <input type="radio"/> No		<input type="checkbox"/>
<input checked="" type="checkbox"/> Description of the physical location where the vehicles transporting biomedical waste are being disinfected	<input type="radio"/> Yes <input type="radio"/> No		<input type="checkbox"/>
<input checked="" type="checkbox"/> Drivers Training Manual (for PCB/Biomedical Waste)	<input type="radio"/> Yes <input type="radio"/> No		<input type="checkbox"/>
<input checked="" type="checkbox"/> A copy of the applicant's Operation Plan including detailed packaging and biomedical waste handling methods	<input type="radio"/> Yes <input type="radio"/> No		<input type="checkbox"/>
<input checked="" type="checkbox"/> Contingency and Emergency Procedures Plan (for PCB/Biomedical Waste/Hauled Sewage (Septage))	<input type="radio"/> Yes <input type="radio"/> No		<input type="checkbox"/>
Other (please describe):	<input type="radio"/> Yes <input type="radio"/> No		<input type="checkbox"/>

6 Supporting Documentation and Technical Requirements

Contents | General Information and Instructions | Application Summary | 1 Applicant Information | 2 Project Information | 3 Regulatory Requirements | 4 Site Information | 5 Facility Information | 6 Supporting Documentation and Technical Requirements | 7 Payment Information

Print Form

Clear Form

Save Form

Attachment	Attached	If no, provide explanation, (include referenced attachment if more space is required for rationale)	Confidential* (✓)
------------	----------	---	-------------------

6.7 Mobile Waste Processing N/A

Design and Operations Report – Mobile Waste Processing of General Waste	<input type="radio"/> Yes <input type="radio"/> No		<input type="checkbox"/>
Design and Operations Report – Mobile Waste Processing of Liquid Waste	<input type="radio"/> Yes <input type="radio"/> No		<input type="checkbox"/>
Other (please describe): <input type="text"/>	<input type="radio"/> Yes <input type="radio"/> No		<input type="checkbox"/>

6.8 Cleanup of Contaminated Sites N/A

Design Report for Cleanup of Contaminated Sites	<input type="radio"/> Yes <input type="radio"/> No		<input type="checkbox"/>
Other (please describe): <input type="text"/>	<input type="radio"/> Yes <input type="radio"/> No		<input type="checkbox"/>

6.9 Other Attachments N/A

Title	Reference	Confidential* (✓)
<input type="text"/>	<input type="text"/>	<input type="checkbox"/>
<input type="text"/>	<input type="text"/>	<input type="checkbox"/>
<input type="text"/>	<input type="text"/>	<input type="checkbox"/>
Are you attaching an additional list of attachments? <input type="radio"/> Yes <input checked="" type="radio"/> No	If there is not enough space to list all of the attachments included in this application package, please include an additional listing of these attachments.	

*Please note: The collection of personal information in this application is necessary to administer the Ministry's approvals program, which is authorized pursuant to the Environmental Protection Act and the Ontario Water Resources Act. The personal information collected in this application will be used to administer the program, including for the purposes of the Ministry's compliance and enforcement activities under the aforementioned acts, and for the purposes of making information in respect of Environmental Compliance Approvals available to the public with the exception of payment information. Questions about the collection of the information can be directed to a Client Service Representative, Environmental Approvals Access and Service Integration Branch, 2 St. Clair Avenue West, Floor 12A, Toronto Ontario M4V 1L5; Telephone outside Toronto 1-800-461-6290 or in Toronto 416-314-8001 or Fax 416-314-8452.

This page has been intentionally left blank, please proceed to page 45 for Payment information.

Attachment 1

Proof of Legal Name

Ministry of
Consumer and
Business Services

Ministère des Services
aux consommateurs
et aux entreprises



Registration Division
Companies and Personal
Property Security Branch
393 University Ave., Suite 200
Toronto ON M5G 2M2

Division de l'enregistrement
Direction des compagnies et
des sûretés mobilières
393, av. University, bureau 200
Toronto ON M5G 2M2

January 8, 2004

Corporations Information Act

Your Reporting Requirements

WASTE MANAGEMENT OF CANADA
CORPORATION
NICOLA QASEM
20 SIMMONDS DRIVE
DARTMOUTH NS B3B 1R3

This is your Ontario Corporation Number (OCN)

1600554

Regulations require that this number is stated in all notices submitted under the *Corporations Information Act*. This number must be stated in ALL correspondence with the Companies and Personal Property Security Branch.

Initial Return

The *Corporations Information Act* states that every extra-provincial corporation, other than a corporation of a class exempted by the Regulations, that begins to carry on business in Ontario shall file an Initial Return, Form 2, within sixty (60) days after the date the corporation begins to carry on business in Ontario. The Initial Return you have just filed has generated an Ontario Corporation Number and created a file for the public record for your corporation.

Notice of Change

In addition to the Initial Return you have recently filed, you are required to file a Notice of Change for every change in the information within 15 days after the change or changes take place. There is no fee for filing these notices.

Forms

Forms may be obtained from the Ministry at the above noted address or by calling (416) 314-8880, 1-800-361-3223 or TDD (416) 212-1476. Forms are also available on the Ministry's website at www.cbs.gov.on.ca. To access the forms, select the 'Business Information' option at the top of the Ministry's home page.

Business Name

- (a) No corporation shall carry on business in Ontario or identify itself to the public in Ontario by a name other than its corporation name unless the name is first registered. The appropriate registration form may be obtained from the Companies and Personal Property Security Branch or by calling one of the above noted telephone numbers.
- (b) A corporation which has registered and uses a name other than its corporate name is required to set out its corporate name and all registered business names on all contracts, invoices, negotiable instruments and orders for goods or services.

Penalties

Sections 13 and 14 of the *Corporations Information Act* provide penalties for contravening the Act or Regulations.

Section 18(1) of the Act provides that a corporation that is in default of a requirement under this Act to file a notice or that has unpaid fees or penalties is not capable of maintaining a proceeding in a court in Ontario in respect of the business carried on by the corporation except with leave of the court.

Attachment 2

Development & Operations Report for a
Waste Transfer Station Application,
prepared by GENIVAR Inc., September
2012

**Richmond Landfill
081-12493-00**

**Development & Operations Report for a
Waste Transfer Station Application**

August 2012

**Prepared for:
Waste Management of Canada Corporation
1271 Beechwood Road, RR6
Napanee ON K7R 3L1**

**Prepared by:
GENIVAR Inc.
1450 1st Avenue West, Suite 101
Owen Sound, Ontario N4K 6W2**

Project No. 081-12493-00 (8570G)

TABLE OF CONTENTS

EXECUTIVE SUMMARY	I
1.0 SITE DESCRIPTION	1-1
2.0 WASTE STREAM	2-1
2.1 Waste Input	2-1
2.2 Waste Receiving Hours	2-1
2.3 Waste Characteristics	2-1
2.4 Service Area	2-2
2.5 Site Capacity and Quantity	2-2
2.6 Bin Location and Protection	2-2
3.0 SITE TRAFFIC AND ROADS	3-1
3.1 Main Access and Auxiliary Access	3-1
3.2 On-Site Road System	3-1
3.3 Traffic Volumes	3-1
4.0 SITE CONTROLS	4-1
4.1 Staff	4-1
4.2 Scale House	4-1
4.3 Acceptable Waste	4-1
4.4 Signage	4-2
4.5 Staging Area	4-2
4.6 Road Maintenance	4-3
4.7 Litter Control	4-3
4.8 Odour Control	4-3
4.9 Vermin Control	4-4

LIST OF FIGURES

Figure MT1	Site Location Plan, Richmond Landfill, Napanee, Ontario
Figure MT2	Site Plan, Mini-Transfer Areas, Richmond Landfill, Napanee, Ontario

EXECUTIVE SUMMARY

Waste Management of Canada Corporation (WM) is applying to reduce the frequency of waste removal from the public drop-off area (mini-transfer area) at its Richmond Landfill, to an approved facility as detailed in this Development and Operation Report. The Development and Operations Report is submitted as part of supporting information required by the Ministry of Environment as part of the Environmental Compliance Approval Application. This document is intended:

- to support the Request for Approval;
- to provide additional detail on the existing site design and site controls, and
- to provide sufficient information for the regulatory reviewers to issue an amendment to the existing Environmental Compliance Approval.

The attached report is organized into four (4) sections as follows:

- Section 1 discusses the site setting, and provides background information.
- Section 2 describes the waste input, receiving hours, proposed waste characteristics, service area, and site capacity.
- Section 3 discusses haul routes for waste, onsite road system to the transfer facility, and traffic volume.
- Section 4 describes site controls, including:
 - staff;
 - entrance area;
 - control of waste entering the site;
 - signage
 - staging area
 - road maintenance;
 - litter control;
 - odour control; and
 - vermin control.

1.0 SITE DESCRIPTION

Waste Management of Canada Corporation's (WM) Richmond Landfill site is located within Part of Lots 1, 2 and 3, Concession IV, Former Township of Richmond in the Town of Greater Napanee, County of Lennox and Addington, as shown on **Figure MT1**. The landfill consists of a 16.2 hectare waste disposal landfill site within a total site area of 138 hectares, and operates under Environmental Compliance Approval No. A371203, issued January 9, 2012, with subsequent amendments. On June 30, 2011, the Richmond Landfill ceased to accept waste for disposal as per a condition of the Environmental Compliance Approval.

The existing Richmond Landfill has a public drop-off area (mini-transfer area) located at the south end of the landfill site near the site entrance, west of the weigh scales, which was approved to resume operations by the Ministry of Environment on January 9, 2012, subject to the conditions outlined in Environmental Compliance Approval No. A371203. As the largest recycler in North America, WM is committed to providing waste disposal and recycling services to area residents, who would otherwise have to travel out of the area to dispose of their materials. It is WM's plan that the public drop-off area will remain in operation, with the waste being hauled to a transfer station in Trenton, ON or Kingston, ON for disposal.

Since this application is for the continued use of the existing mini transfer area, there is no proposed site work to be completed. This application is intended to outline tonnage limitations, volume of waste stored on site, removal frequencies, and existing environmental controls.

For additional information regarding the description of the site, please refer to the "Development and Operations Report, Richmond Landfill Site, prepared for Laidlaw Waste Systems by Henderson Paddon and Associates Limited, March 1996.

2.0 WASTE STREAM

2.1 WASTE INPUT

The current public drop-off area (mini-transfer area) is located at the south central end of the existing Richmond Landfill, immediately west of the weigh scale, as shown on **Figure MT2**. The drop-off area is for small vehicles and is situated for convenience

Waste to be received at the mini-transfer area is limited to the following:

- Solid Non-Hazardous Waste – Domestic Waste, Construction and Demolition Waste;
- Blue Box Materials;
- Tires; and
- White Goods and Metal.

It is also noted that Waste Management is also permitted to collect electronics, paint, and single use batteries under the various recycling programs instituted by the Province of Ontario. Should Waste Management participate in any future recycling programs developed by the Province, then the waste that has been approved for collection under these programs will also be accepted at the public drop off area.

2.2 WASTE RECEIVING HOURS

Waste will be received at the site from 8:00 a.m. to 5:00 p.m. Monday to Friday, and 8:00am to 1:00 pm on Saturday, excluding statutory holidays.

2.3 WASTE CHARACTERISTICS

The site will receive solid, non-hazardous waste along with recyclable materials. Designated bins are provided and located in the public drop-off area for the various waste types, and the number of bins will be adjusted as required. As per a condition of the Environmental Compliance Approval, the following bins will be a maximum quantity located in the public drop-off area:

- Nine (9) – 40 yard bins for metals, tires, and solid non-hazardous waste consisting of domestic, construction and demolition waste; and
- Two (2) – Eight (8) yard bins for blue box materials.

A building has also been erected east of the bins to house an electronics drop off depot and reuse centre. The building also contains three (3) five-gallon pails for the collection and storage of single use batteries through the Stewardship Ontario program.

2.4 SERVICE AREA

The site's service area is restricted to waste generated within the boundaries of the Town of Greater Napanee, Town of Deseronto, and Tyendinaga Township, which includes the Mohawks of the Bay of Quinte. Residents will be required to provide identification prior to depositing any waste.

2.5 SITE CAPACITY AND QUANTITY

The public drop-off area has a site capacity limited to 50 tonnes, which will be stored at the public drop-off area at any time.

As permitted in the Environmental Compliance Approval, WM is permitted to receive a maximum of 50 tonnes of waste and recyclable material per day. WM is also permitted have a "Large Waste Day" on 25 occasions throughout a single calendar year, where the site can receive up to 100 tonnes per day.

It should be noted that an appropriate amount of Financial Assurance has been already provided for the removal of the existing transfer area. However, additional funds will also be provided for specific items related to the operation of this facility.

2.6 BIN LOCATION AND PROTECTION

The waste bins at the public drop-off area are located outside. Bins which contain newspaper or cardboard shall be covered, with openings on the side that permit access for residents to place material in the bin.

For additional information regarding the waste stream at the landfill, please refer to the "Development and Operations Report, Richmond Landfill Site", prepared for Laidlaw Waste Systems by Henderson Paddon and Associates Limited, March 1996.

3.0 SITE TRAFFIC AND ROADS

3.1 MAIN ACCESS AND AUXILIARY ACCESS

The existing landfill site has an entrance located approximately 1,200 metres west of Lennox and Addington County Road 10, just north of Beechwood Road. This site entrance has been suitable and will remain suitable for the current use.

For additional information regarding main access and alternative emergency exits, please refer to the "Development and Operations Report, Richmond Landfill Site, prepared for Laidlaw Waste Systems by Henderson Paddon and Associates Limited, March 1996.

3.2 ON-SITE ROAD SYSTEM

For the existing landfill, once the public enters the landfill site, they will proceed to the weigh scale and scale house to communicate with the site scale attendant. They will then be directed to the mini-transfer area located immediately west of the weigh scale area, where they will turn left and pull alongside, or back up to the appropriate required bin or building, and deposit the waste materials. The public will then either return to the weigh scale, if required, or will exit the site.

The site road will be suitable for all-weather site access.

3.3 TRAFFIC VOLUMES

Traffic to the public drop-off areas is anticipated to be generated from the following sources:

- local, small load vehicles consisting of cars, trailers and pickups delivering small volumes of waste to the mini transfer station or visiting the recycle drop-off area; and,
- roll-off trucks, to remove bins to the approved transfer station facility for disposal.

Since the landfill no longer accepts waste for landfilling, a negligible amount of traffic volume will be generated from this proposal.

4.0 SITE CONTROLS

4.1 STAFF

The existing staff will be suitable for operation of the public convenience areas. Presently, site weigh scale attendants and labourers to pick litter are only required. No additional labour will be required.

4.2 SCALE HOUSE

For the existing landfill, the current scale house will be suitable for the public entering the site to use the public convenience area for waste disposal.

Scale house personnel will control the flow of traffic into and out of the site. Traffic lights will signal red to stop before entering onto the scale and green for proceeding off the scale. Loads are inspected to the extent possible at the scale house. Drivers are questioned regarding the contents and origin of the load, and if any hazardous waste is present. Speakers allow the scale house personnel to communicate verbally with the vehicle operators entering or leaving the site, and to direct small vehicles to the public drop-off area and reuse centre just beyond the scale. Weight tickets and tare weights will be issued and recorded from the scale house. Records of the types and amounts of waste are tracked using FastLane software, and are provided in the annual report.

4.3 ACCEPTABLE WASTE

As per a condition of the Environmental Compliance Approval, the public drop-off area will accept the following types of waste:

- Solid Non-Hazardous Waste (Domestic and Construction/Demolition Waste);
- white goods and metal, including tagged refrigeration white goods and empty propane tanks;
- electronics;
- tires;
- blue box recyclables; and
- single use batteries.

4.4 SIGNAGE

- Waste Type Signs

A sign pointing to the mini transfer area after the weigh scale is already in place.

MINI TRANSFER AREA

- Waste and Diversion Area Bins

Waste and diversion area bins have signs to indicate:

- various recyclables;
- domestic waste;
- tires;
- electronics and batteries; and
- white goods and metal

Please refer to the “Development and Operations Report, Richmond Landfill Site, prepared for Laidlaw Waste Systems by Henderson Paddon and Associates Limited, March 1996, for additional information regarding site controls.

4.5 STAGING AREA

Upon exiting the scale with their loads, small vehicles will enter the public drop-off area and pull up to the appropriate bins or building to throw off their loads. Reusable goods are placed in the reuse centre, where items can also be exchanged. The bins will be moved by trucks to dispose of waste offsite at an approved waste disposal site.

The public drop off area is in clear view of the scale house, and WM staff regularly patrol the public drop off area. If an unsuitable load is brought to the area, or if any unsuitable waste has been deposited, it will be refused or removed from the site in an appropriate manner.

4.6 ROAD MAINTENANCE

The site access road is paved from the scale area to Beechwood Road to minimize mud tracking onto municipal roads. As required, the sweeper attachment for the loader is used to sweep material from site roads, and for a portion of Beechwood Road.

4.7 LITTER CONTROL

WM will have an active and comprehensive litter control program. Litter will be retrieved from

- the access roads;
- on site; and,
- adjacent properties and on more remote properties, if required.

WM will inspect and collect litter and debris from the site on a weekly basis. Material collected will be disposed in the appropriate bin, which will then be removed to the transfer station for disposal.

4.8 ODOUR CONTROL

WM has an active and comprehensive odour control program. Site inspections and surveys of the surrounding area are completed weekly, while the public drop off area is regularly monitored.

Due to the low volume of waste that is received at the public drop-off area, the waste bins in the mini-transfer area will be removed to an approved waste facility at a frequency of once every two weeks. In the event that odours are detected from the waste, the material will be removed from the facility immediately and therefore potential odours will be greatly minimized.

In the event that a complaint regarding odour is received from local residents, a log will be completed which will include the date and time of the complaint, weather conditions, and the steps completed by WM to investigate the source of the odour. Within one (1) week of the complaint date, WM will complete a report listing the actions taken to resolve the complaint, recommendations for remedial measures, and any changes that were made to avoid the recurrence of similar incidences.

WM is able to complete a response plan if complaints are received directly by WM. If complaints are delayed or not directed towards WM, the potential odour source cannot be investigated nor can corrective action be taken if the odour was potentially landfill related.

All complaints and reports will be included in the odour log and in the site annual report.

For additional information regarding odour control, please refer to the "Richmond Sanitary Landfill Site Odour Monitoring Plan Revision No. 1", prepared for Waste Management of Canada by GENIVAR Inc., March 2012.

4.9 VERMIN CONTROL

WM has an active vermin control plan at the Richmond Landfill. A weekly inspection, monitoring, bait and poison program is performed on the bins and all buildings by a licensed pest control company. WM personnel also monitor the public drop off facility and the entire site on a weekly basis for signs of vermin.

To date, there have been no issues with vermin at the Richmond Landfill. In the event that a problem is caused by the increased period of waste retention at the public drop off facility, WM will immediately remove the waste and consult with a licensed pest control company eradicate the vermin.

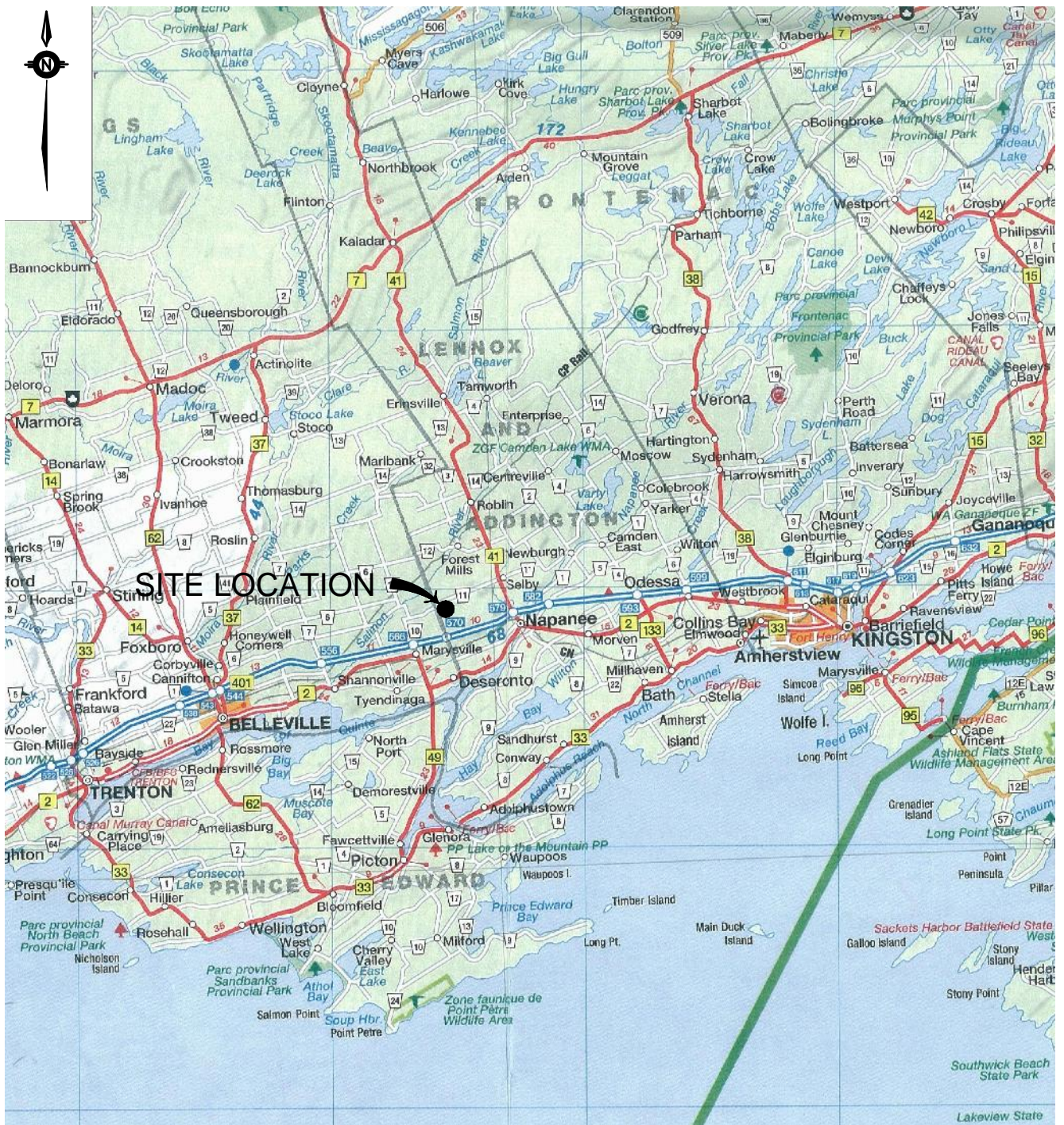

c:\1985_8570G\DRAW\2012 D&G Transfer Station Design\Figure MT1.dwg

SHEET
MT1

DWN BY: TCG DATE: AUGUST 2012
CHK BY: JEA SCALE: SEE BAR SCALE
WASTE MANAGEMENT OF CANADA CORP.
DRAWING NO. **8570713-MT1**

SITE LOCATION PLAN
RICHMOND LANDFILL



GENIVAR
1450 1st Ave W, Suite 101, Owen Sound, ON, N4K 6W2
Telephone: (519) 376-7612 / Fax: (519) 376-8008
Toll Free: 1-888-376-7612

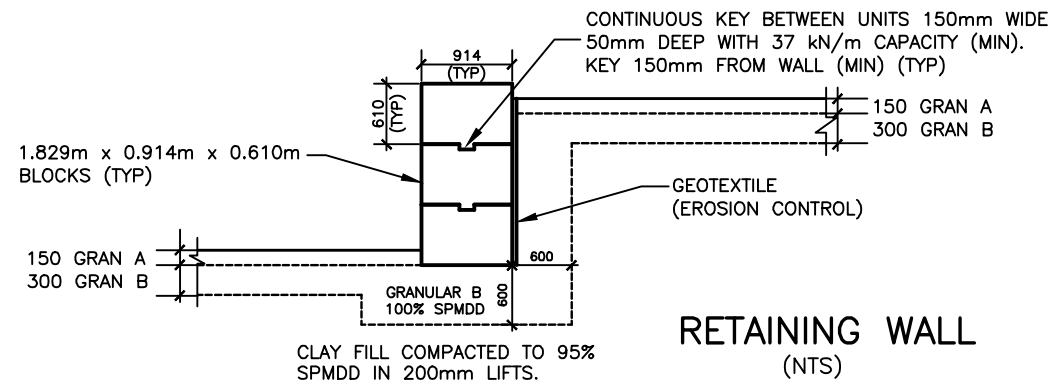
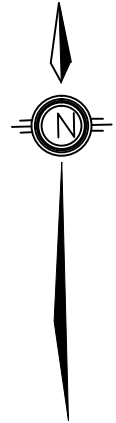
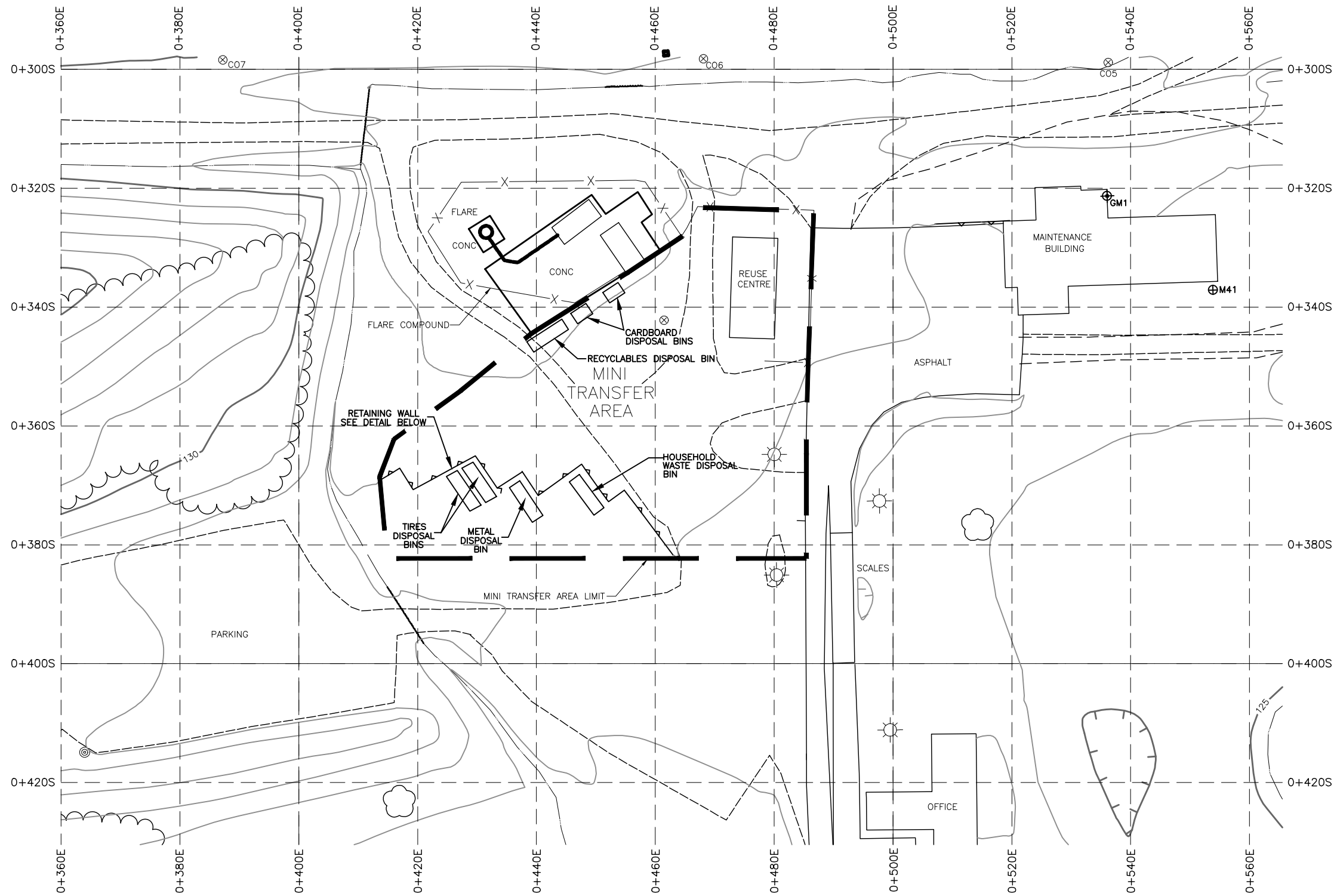

RETAINING WALL
(NTS)

NOTES:

1. LOCATION OF BINS ARE DEPICTED AS RECORDED DURING SITE VISIT BY GENIVAR INC. ON JULY 23, 2012.
2. ECA NO. A371203 PERMITS WM TO HAVE A MAXIMUM OF NINE (9) 40 YARD BINS FOR METALS, TIRES, AND SOLID NON-HAZARDOUS WASTE CONSISTING OF DOMESTIC, CONSTRUCTION AND DEMOLITION WASTE. THE ECA ALSO PERMITS A MAXIMUM OF TWO (2) EIGHT (8) YARD BINS FOR BLUE BOX MATERIALS, AND THREE (3) FIVE (5) GALLON PAILS FOR SINGLE USE BATTERIES.

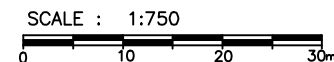

C:\1288\B7000\B7000\2012\040 Transfer Station Drop\Figure MT2.dwg Sep. 12, 2012 - 8:26am

Attachment 3

Site Location Map



G:\1985\85700\2012\Application to Amend Transfer Station\2012\Attachment 3 - Site Location Map\8570-F1-GENVAR.dwg

SHEET
1.1

DWN BY: TCG DATE: MAR 2004
CHK BY: JEA SCALE: SEE BAR SCALE
WASTE MANAGEMENT OF CANADA CORP.
DRAWING NO. Figure 1.1

SITE LOCATION PLAN
RICHMOND LANDFILL



GENIVAR
1450 First Avenue West, Suite 101,
Owen Sound, ON, N4K 2K8
Telephone: (519) 376-7612 / Fax: (519) 376-8008

Attachment 4

Georeferencing Information

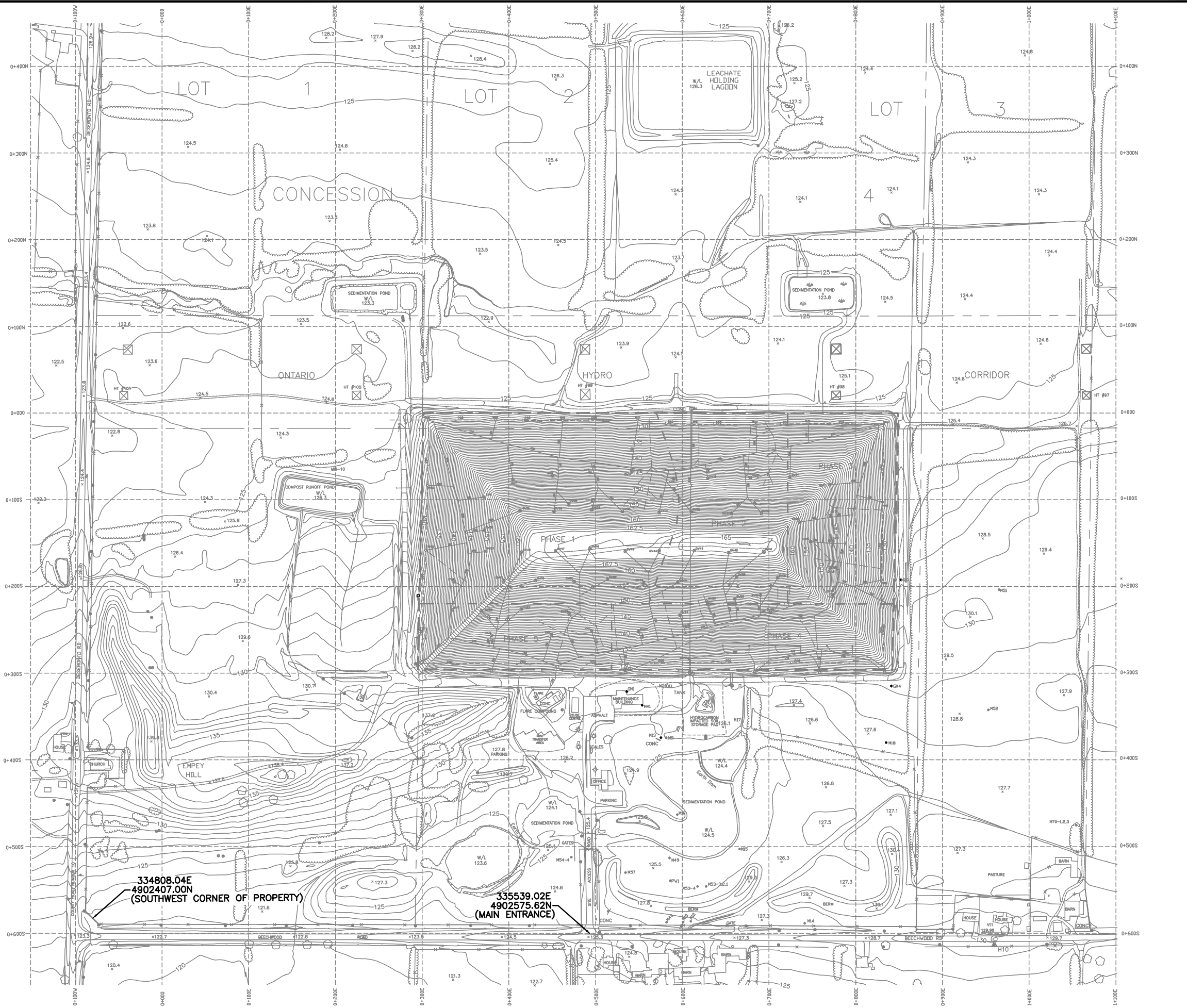

334808.04E
4902407.00N
(SOUTHWEST CORNER OF PROPERTY)

335539.02E
4902575.62N
(MAIN ENTRANCE)



LEGEND:

- INDEX CONTOURS
- INTERVAL CONTOURS
- REFERENCE GRID LINE
- LEGAL BOUNDARIES
- APPROVED LIMIT OF LANDFILL
- PHASING LIMITS
- EXISTING DRAINAGE DITCH
- EXISTING WEEPER
- EXISTING GAS LATERAL
- EXISTING FENCE LINE
- EXISTING TREE LINE
- HT #88
- HT #96
- HT #97
- EXISTING ROAD EDGE
- BEDROCK WELL LOCATION
- GAS MONITOR LOCATION
- OVERBURDEN WELL LOCATION
- EXISTING LEACHATE MAN-HOLE
- GAS WELL
- EXISTING TREE

NOTES:

- 1) EXISTING GROUND CONTOURS AND TOPOGRAPHIC INFORMATION SHOWN IS BASED ON INFORMATION OBTAINED FROM AERIAL PHOTOGRAPHY FLOWN ON JUNE 27, 2009 BY BASE MAPPING. WELL LOCATIONS AND LANDFILL MOUND CONTOURS WERE UPDATED FROM FIELD SURVEY DATA BY GENIVAR INC. TO NOVEMBER 16, 2011
- 2) CONTOUR INTERVAL SHOWN IS 0.5m
- 3) THE LOCAL SITE GRID IS BASED ON 0+000N BEING THE NORTH LANDFILL LIMIT. THE NORTH WEST CORNER OF THE LANDFILL LIMIT IS 0+300E AND IS PERPENDICULAR TO THE EAST/WEST GRID LINE. THE WEST LIMIT OF THE LANDFILL IS LOCATED ALONG THE LOT LINE BETWEEN LOTS 1 AND 2, CONCESSION 4.

B.M. #1 ELEV. = 124.667
TOP OF BRACKET, NORTH WEST LEG OF HYDRO TOWER NO. 99, LOCATED ±25m NORTH AND ±180m EAST OF NORTH WEST CORNER OF APPROVED LANDFILL LIMIT.

B.M. #2 ELEV. = 125.146
TOP OF BRACKET, NORTH WEST LEG OF HYDRO TOWER NO. 100, LOCATED ±25m NORTH AND ±80m WEST OF NORTH WEST CORNER OF APPROVED LANDFILL LIMIT.

SCALE: 1:2000

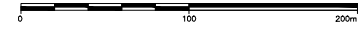

Attachment 5

Documentation in support of EBR Exception, in the form of an email exchange between Mr. Randy Harris, WM Landfill Manager, and Mr. David Arnott, Provincial Officer, Ministry of Environment, Kingston District Office

From: Arnott, David (ENE) [<mailto:David.Arnott@ontario.ca>]
Sent: Tuesday, August 14, 2012 12:35 PM
To: Harris, Randy - BEN
Subject: RE: Public Drop off

Hi Randy,

I've spoken with our Approvals Branch. It doesn't appear that an amendment application to implement the change below would require an EBR posting. We would however want details or plans for addressing or assessing potential odour/vermin issues which are also conditions of the ECA and which on the surface, in theory could be impacted by a prolonged removal period. We could discuss that though during the application process if WM wanted to proceed. Any other questions please advise.

Dave

David Arnott
Provincial Officer #827
Ontario Ministry of the Environment
Kingston District – Operations Division

Dir Line: 613-540-6899 Fax: 613-548-6920
www.ene.gov.on.ca

Spills Action Centre: 1-800-268-6060
Pollution Hotline (Anonymous): 1-866-MOE-TIPS

From: Harris, Randy - BEN [<mailto:rharris@wm.com>]
Sent: August 14, 2012 7:52 AM
To: Arnott, David (ENE)
Subject: Public Drop off

Hi David.....Awhile back we discussed an issue here at the landfill concerning our public drop off and I would like to email a more formal request for information sake. As per our amended C of A (condition 149) we required to dispose of trash from the bins to a transfer station twice a week. However as per condition 145 we are allowed have up to 50 tonnes per day on site. The issue is that on some days to comply with condition 149 we are lifting a bin with less than 2 tonnes of trash in it. In fact since we began this operation I have not seen a full bin removed yet. My question is would a request to change condition 149 require a posting on the EBR? Please advise.

Randy Harris
Site Manager

W
Richmond Landfill
Beechwood Road Environmental Centre

613-388-1057

**Waste Management recycles enough paper every year to save 41 million trees.
Please recycle any printed emails.**

Attachment 6

Proof of Consultation/Notification



WASTE MANAGEMENT

1271 Beechwood Road
Napanea, ON K7R 3L1
(613) 388-1057
(613) 388-2785 Fax

081-12493-00 (8570G)

September 13, 2012

To: Local Residents

Re: Waste Transfer Station Approval Amendment
Waste Management of Canada Corporation – Richmond Landfill Site

Dear Resident:

Waste Management of Canada Corporation has applied to the Ministry of the Environment to decrease the frequency of waste removal from the public drop off area at the Richmond Landfill from two times per week, to one time every two weeks. Waste Management is applying for this approval to allow for the better management and handling of waste materials.

Should you have any questions, concerns, or objections to the proposal, you must send written comments to:

Director, Environmental Approvals – Access and Service Integration Branch
Ministry of Environment
2 St. Clair Avenue West, Floor 12A
Toronto, ON M4V 1L5

Written comments must be received within 15 days of receipt of the notice. Should you have any questions or comments regarding the application before expressing these comments to the Ministry, please do not hesitate to contact Mr. Randy Harris at the Richmond Landfill site.

Yours very truly,

WASTE MANAGEMENT OF CANADA CORPORATION

A handwritten signature in black ink that reads 'Randy Harris' in a cursive script.

Mr. Randy Harris – Landfill Manager

Waste Management of Canada Corporation - Richmond Landfill
 Application to Amend Environmental Compliance Approval No. A371203 (Waste Transfer Station)

Notification to Neighbouring Residents of Application Submission

Resident Name	Residence Address	Date of Delivery/Method
Mrs. Martin	1097 Beechwood Road, Napanea, ON	resident deceased - but letter left in mailbox Sept 13/ 2012
Mr. and Mrs. Paul Martin	1121 Beechwood Road, Napanea, ON	hand delivered to mailbox on Sept 13/2012
Mr. and Mrs. Andrew Martin	1144 Beechwood Road, Napanea, ON	hand delivered to mailbox on Sept 13/2012
Mr. Doug Lewis	1250 Beechwood Road, Napanea, ON	hand delivered to mailbox on Sept 13/2012
Mr. and Mrs. Lyn Russell	3424 Selby Road, Napanea, ON	hand delivered to mailbox on Sept 13/2012
Mr. and Mrs. Larry Austin	3596 Selby Road, Napanea, ON	hand delivered to mailbox on Sept 13/2012
Mary Blair and Leona Wells	3684 Selby Road, Napanea, ON	hand delivered to mailbox on Sept 13/2012
Mr. Bob Russell	3591 Selby Road, Napanea, ON	hand delivered to mailbox on Sept 13/2012
The Bakers	3462 Selby Road, Napanea, ON	hand delivered to mailbox on Sept 13/2012
Mr. and Mrs. Paul Blackburn	3582 Selby Road, Napanea, ON	hand delivered to mailbox on Sept 13/2012
R. C. Murray	3703 Selby Road, Napanea, ON	hand delivered to mailbox on Sept 13/2012
Mr. and Mrs. Leo Walsh	3832 Selby Road, Napanea, ON	hand delivered to mailbox on Sept 13/2012
Resident	1464 Callaghan Side Road, Napanea, ON	hand delivered to mailbox on Sept 13/2012
Mr. and Mrs. Harold Scharf	1398 Callaghan Side Road, Napanea, ON	hand delivered to mailbox on Sept 13/2012
Mr. and Mrs. Doug Cranston	1388 Callaghan Side Road, Napanea, ON	hand delivered to mailbox on Sept 13/2012
Mr. and Mrs. Cory Wilson	1360 Callaghan Side Road, Napanea, ON	hand delivered to mailbox on Sept 13/2012
Mr. Ken Brown	1379 Callaghan Side Road, Napanea, ON	hand delivered to mailbox on Sept 13/2012
Mrs. Leona Tucker	1517 Deseronto Road, Marysville, ON	hand delivered to mailbox on Sept 13/2012
Mr. and Mrs. James Shearer	172 Tuckers Lane, Marysville, ON	hand delivered to mailbox on Sept 13/2012
Mr. Gary Tucker	138 Tuckers Lane, Marysville, ON	hand delivered to mailbox on Sept 13/2012

Waste Management of Canada Corporation - Richmond Landfill
Application to Amend Environmental Compliance Approval No. A371203 (Waste Transfer Station)

Notification to Neighbouring Residents of Application Submission

Resident Name	Residence Address	Date of Delivery/Method
Mr. and Mrs. Ron Allison	207 Tuckers Lane, Marysville, ON	hand delivered to mailbox on Sept 13/2012
Mr. Tim Dillenbeck	66 Johnson Side Road, Napanea, ON	hand delivered to mailbox on Sept 13/2012
Ms. Julie Butcher	66 Johnson Side Road, Napanea, ON	hand delivered to mailbox on Sept 13/2012
Resident	67 Johnson Side Rd, Napanea ON	hand delivered to mailbox on Sept 13/2012
Resident	71 Johnson Side Rd, Napanea ON	hand delivered to mailbox on Sept 13/2012
Resident	75 Johnson Side Rd, Napanea ON	hand delivered to mailbox on Sept 13/2012
Andersons	185 Johnson Side Rd, Napanea ON	hand delivered to mailbox on Sept 13/2012
Mr. and Mrs. Brian Powers	603 Kennelly Road, Napanea, ON	hand delivered to mailbox on Sept 13/2012
Mr. Charles Goodfellow	554 Kennelly Road, Napanea, ON	hand delivered to mailbox on Sept 13/2012
Mr. Shaun Kennelly	494 Kennelly Road, Napanea, ON	hand delivered to mailbox on Sept 13/2012

NOTE: 3427 Selby Road has no mailbox, therefore no letter was left.